

Index of Services

FERIA VALENCIA
2022

ESPACIO
COCINA SICI

MANDATORY SHOW SERVICES

Forms of Payment and Guarantee	0	0A
Insurances	1	
Electric Supply	2A	2B 2C

EXCLUSIVE SHOW SERVICES

Electric Supply (Power) ...	10A	10B	10C
	11	11A	11B
Structures and Rigging	11C	11D	
Furniture and Accessories	12	12A	12B 12C
	12D	12E	12F 12G
Broadband and Internet Connection	13		
Carpeting	14		
Wooden Platform	15		
Meeting Rooms	16		
Parking	17		
Water	18	18A	
Compressed Air	19	19A	
Cranes and Goods Delivery	20		
Press Services	21		
Telephone Line	22		

PASSES AND EXHIBITORS CARDS

Assembly and Dismantling Passes	60
Exhibitor Cards	61

ADDITIONAL SHOW SERVICES

Stand Design and Decoration	30	
Hotels	31	
Waste Removal Service	32	32A
Electrical Accessories	33	33A
	33B	33C
Hostess	34	
Auxiliary Personnel	35	
Audiovisuals	36	36A
Computers	37	
Floral Decoration	38	
Coffee and Beer Draft	39	
Electrical Appliances	40	
Mannequin and Racks	41	
Photography and Video	42A	42B
Catering Service	44	
Vinyls and Giant Prints	45	
Painting Service for Stands	49	
Entertainment Service	50	

ADVERTISING SERVICES

Exhibition Venue	52
------------------------	-----------

2022

TRADE FAIR:

Exhibiting Firm:

Contact:

Stand Number:

E-mail:

Please complete the following form if the person responsible for payment is different to exhibitor.

BILLING INFORMATION

Please fill-in the following billing information that will be used in all the invoices issued by Feria Valencia:

Billing address:
Street/PO box:
Postcode/town:
Contact: E-mail:
Phone: Fax:
VAT registration n°.:

Please indicate the services for which the person responsible wishes to make payment:

- Insurances
- Electric Supply
- Electric Supply (Power)
- Structures and Rigging
- Broadband and Internet Connection
- Carpeting
- Wooden Platform
- Meeting Rooms
- Parking
- Water
- Compressed Air
- Cranes and Goods Delivery
- Press Services
- Telephone Line
- Stand Design Decoration
- Hotels
- Waste Removal Service
- Electrical Accessories
- Hostess
- Auxiliary Personnel
- Audiovisuals
- Computers
- Floral Decoration
- Coffee and Beer Draft
- Electrical Appliances
- Mannequin and Racks
- Photography and Video
- Goods Delivery and Printing
- Catering Service
- Vinyls and Giant Prints
- Waste Collection
- Painting Service for Stands

PLEASE SEND THIS FORM BY: servicecenter@feriavalencia.com

Date, signature, and company stamp

2022

TRADE FAIR:

Exhibiting Firm:

Contact:

Stand Number:

E-mail:

FORMS OF PAYMENT

Feria Valencia offers the following forms of payment, up to 7 days before assembly begins:

1. Bank Transfer to one of the following account numbers:

Banco	IBAN	Swift (BIC)
BBVA	ES84 0182 5941 4102 0150 5396	BBVAESMM
SANTANDER	ES19 0049 1827 8021 1043 8817	BSCHEM33
CAIXABANK	ES61 2100 0736 0822 0047 7030	CAIXESBBXXX

2. Make cheques payable to 'Feria Muestrario Internacional de Valencia' (in EUR, **TRADE FAIR NAME**).

3. Credit Card

If less than 7 days before assembly, cash payment by bank transfer or credit card.

Please send payment confirmations to:

·Treasury Office: Phone: +34 963 861 292 - Fax +34 963 861 291 - E.mail: tesoreria@feriavalencia.com

For any questions, please contact:
E-mail: servicecenter@feriavalencia.com - Phone: +0034 96 386 11 05

2022

TRADE FAIR:

Exhibiting Firm:

Contact:

Stand Number:

E-mail:

As a precautionary measure for any incident that may occur during your participation at the fair, FERIA VALENCIA offers the possibility of contracting various insurance policies, of which INSURANCE AGAINST FIRE AND FLOODING is the only one OBLIGATORY REQUIRED.

To contract this service, it is necessary to fill in this form.

1. OBLIGATORY FIRE AND FLOOD DAMAGE INSURANCE

The abovementioned exhibiting firm DECLARES, for insurance coverage matters, under its responsibility the declared values. In case of not filling in the corresponding inventory, (stated below) the following values per every 16 sg.m will be charged: Content: 2.400 euros - Stand: 450 euros.

And demands also the insurance which, with a voluntary character, the Fair puts at its disposal for the following risks and amounts:

QUANTITY	TYPE OF MATERIAL	EUROS
<input type="text"/>	Contents of stand	<input type="text"/>
<input type="text"/>	Merchandise	<input type="text"/>
<input type="text"/>	Decoration and furniture	<input type="text"/>
SUBTOTAL		<input type="text"/>
Stand structure (not included in insurance against theft)		<input type="text"/>
TOTAL		<input type="text"/>

NOTE: Attacher inventory with economic valuation and photos

2. THEFT (Not pilferage) YES NO
3. BREAKAGE DURING THE EXHIBITION YES NO
4. CIVIL LIABILITY COVERING DAMAGES TO THIRD PARTIES YES NO

DEADLINE FOR SENDING THIS FORM: 4 WORKING DAYS BEFORE SET-UP. ANY APPLICATION RECEIVED WITH LESS THAN 4 WORKING DAYS BEFORE THE START OF SET UP, WILL IMPLY A 25% SURCHARGE ON THE TOTAL RATE. AVAILABILITY OF ALL REFERENCES IS NOT GUARANTEED. PLEASE SEND THIS FORM BY E-MAIL: servicecenter@feriavalencia.com

Date, signature, and company stamp

RATES AND CONDITIONS

2022

Rates (VAT not included)

Compulsory fire insurance and flood damage (*) (**)	3‰
Voluntary insurance against theft (not pilferage) (*) (**)	3‰
Voluntary insurance of breakage during the Fair	5‰
Voluntary insurance of civil liability (cover 600.000 euros)	55 euros

(*) In the case of ANTIQUE and the JELLEWERY AND WATCHMAKING FAIR it will be 7‰
 (**) In the case of the AUTOMOBILE TRADE FAIR it will be 1‰

1. Fire and flood damage.

The Fair offers a general insurance policy against fire and damage by flooding, covering all merchandise and the structure of the stands of exhibitors, who are obliged to declare their full value and pay the corresponding insurance premium.

2. Theft (not pilferage).

Voluntary insurance against theft does not include pilferage. During the opening hours of the fair, and during the periods set aside for setting up and dismantling, the exhibitor is directly responsible for the security of goods on exhibit in its stand.

3. Breakages during the Fair.

This policy covers risks of breakage that goods may suffer during the time they are being exhibited on the stand, including unpackaging and packaging operations on the premises for subsequent display or removal goods, whoever the person or people causing the damage may be. This policy is therefore much wider in scope and coverage than the policy described in point 3.

4. Civil Liability.

To avoid the application The Civil liability policy covers damages with respect to third parties occurring as a result of its participation in the fair. Independently of obligation incurred by exhibitors of adopting all such safety and protection measures as required by current legislation. There is deductible coverage per claim of 150 euros.

5. Proportional Rule.

To avoid the application of the proportional rule, exhibitors are required to state the total value of all exhibited goods, including stand decoration and installations, when taking out Compulsory Fire and flooding as well as the Voluntary Theft Insurance policies. In the event of not filling out the corresponding inventory, the following values will be fixed for each 16m² module: Content: 2,400 euros - Stands: 450 euros.

6. Validity of Policies.

Insurances policies only provide coverage during the officially stipulated periods for setting-up, the fair itself, and subsequent dismantling. For this purpose, and in the exhibitor's own interest, we strongly recommend filling the form in and returning it by the given deadlines.

7. General Conditions.

In all cases, the general and specific conditions stipulated in the Trade Fair's policy with the Insurance Company will be applicable. In case there is any private fire and damage by flooding insurance agreements held by exhibitors certificate from your Insurance Company must be supplied expressly stating that it "renounces any right to reclaim against FERIA VALENCIA". In any case, "loss of profit" is not included.

Certificate and documentation must be sent to: servicecenter@feriavalencia.com

8. VAT.

Application current VAT.

9. EXAMPLE 1

Company ABC has 128 sq.m. How is calculated the obligatory insurance?

- Numer of modules = $128 / 16 = 8$
- For each module of 16 sq.m, the company has to pay 3‰ of the content (2.400€) and the stand (450€)
- $2.400€ + 450€ = 2.850€ \times 8 \text{ modules} = 22.800€$
- $22.800€ \times 3‰ = 68,40€$ is the amount of the insurance.

EXAMPLE 2

Company ABC declares goods for a value of 30.000€. How is calculated the obligatory insurance?

- $30.000€ \times 3‰ = 90,00€$ is the amount of the insurance.

2022

TRADE FAIR:	
Exhibiting Firm:	
Contact:	Stand Number:
E-mail:	

The present document is an application form for electricity supply in Feria Valencia, mainly for lighting.

The exhibitor must request, through the present document, the power and circuit breaker panel boards required during the fair. Both services are supplied by Feria Valencia for all stands.

Charges for circuit breaker panel boards and 24 hour services are according to the power requested (both are charged to the assembling company or the exhibitor):

RATES (VAT not included)

CIRCUIT BREAKERS-DIFFERENTIAL (CONTRACT REQUIRED)	UNIT COST	UNITS
Service entrance, single-phase 3kW general circuit breaker panel board (230 V, up to 16 amps) and installation certificate.	35,00 €	
Service entrance, three-phase 9kW general circuit breaker panel board (400 V, up to 16 amps) and installation certificate.	55,00 €	
Service entrance, three-phase 12kW general circuit breaker panel board (400 V, up to 25 amps) and installation certificate.	76,00 €	
Service entrance, three-phase 18kW general circuit breaker panel board (400 V, up to 32 amps) and installation certificate.	100,00 €	
Service entrance, three-phase 36kW general circuit breaker panel board (400 V, up to 63 amps) and installation certificate.	300,00 €	
NOTE: The three-phase general circuit breaker panel boards have 3P+N+E female CETAC sockets for the connection of the necessary distribution panel boards, which may be rented.		
PERMANENT 24 HOUR POWER SUPPLY	UNIT COST	UNITS
24 hour electricity service up to 2000 watts (connection, protection and consumption). Only available for perishable goods at the exhibition.	165,00 €	
OPTIONAL DISTRIBUTION PANEL BOARDS	UNIT COST	UNITS
Three-phase 9kW distribution panel board (400V, up to 16 amps). Includes three, 16 amps magnetothermal circuit breakers for three 2P+E female CETAC sockets.	34,00 €	
Three-phase 12kW distribution panel board (400V, up to 25 amps). Includes six, 16 amps magnetothermal circuit breakers for three 2P+E female CETAC sockets.	45,00 €	
Three-phase 18kW distribution panel board (400V, up to 32 amps). Includes six, 16 amps magnetothermal circuit breakers for six 2P+E female CETAC sockets.	82,00 €	
ADDITIONAL CETAC SOCKETS	UNIT COST	UNITS
10/16 Amp 2P + T Plug	3,50 €	
32-Amp plug 3P+N+T	9,00 €	
63-Amp plug 3P+N+T	44,41 €	

Charges for electricity consumption will be charged to the exhibitor, according to the total power set up, which will be the sum of the power rating in the general circuit breaker panel boards required:

FAIR DURATION (DAYS) / PRICE OF KW POWER SET UP IN GENERAL CIRCUIT BREAKER PANEL BOARDS (EUROS)

1 day..... 10,20 € 2 days..... 16,61 € 3 days..... 20,53 € 4 days..... 23,52 €
 5 days..... 29,61 € 6-7 days..... 31,13 € 8-9 days..... 34,86 €

The closing date for contracting these services is one month prior to the start of the fair. Feria Valencia reserves the right to reject any applications received after the said date.

DEADLINE FOR SENDING THIS FORM: 1 MONTH BEFORE SET-UP. ANY APPLICATION RECEIVED WITH LESS THAN 4 WORKING DAYS BEFORE THE START OF SET UP, WILL IMPLY A 25% SURCHARGE ON THE TOTAL RATE. AVAILABILITY OF ALL REFERENCES IS NOT GUARANTEED. PLEASE SEND THIS FORM BY E-MAIL: servicecenter@feriavalencia.com

Date, signature, and company stamp

IMPORTANT:

In order for the correct setting up of the panel boards, a plan of their location (with the limits given in centimetres) must be sent a month before the start of the exhibition to the following this email: servicecenter@feriavalencia.com.
On the plan, the walls of the stand must be labelled with "neighbour" or "corridor" so that the plan can be correctly read. Please note that the service entrance is normally done via outlet boxes found on the floor and so the outlet boxes or panel boards used for the stand must be accessible at all times and must not be covered by any platforms or other surfaces which cannot be easily and immediately removed.

SERVICE CONDITIONS:

- In case of cancellation of a service one month prior to the start of an exhibition, 25% of the corresponding charge must be paid.
- Any change or cancellation made to a service which has already been contracted, and which has already been rendered or set up, must be paid entirely and a new charge for the new service contracted will apply.
- The service entrance and general circuit breaker panel boards, according to the application sent, are included.
- The electrical certification of the stand emitted by the contracted assembling company is included.
- The service is a rental service and so any damages, loss or anomaly in the equipment will always be charged to the assembling company.
- The electricity supply for the stand other than that of the general circuit breaker panel board is not included.
- The differential protection for all the general circuit breaker panel boards has a sensitivity of 30mA, as established by the Low Power Electromagnetic Regulations (R.E.B.T. in Spanish, Royal Decree 842/2002) and the Additional Technical Instructions (see legally binding regulations annex for the electricity supply in Feria Valencia).
- Each general circuit breaker panel board has a Schuko single-phase base, of up to 16 amps, for the assembly of the stand. The final electricity connection to the stands will start 4 days before the start of the fair, provided that the electricity supply for the stand has been set up and that the certification is positive, according to the R.E.B.T. regulations, the Additional Technical Instructions and the Feria Valencia regulations.
- The 9kW, three-phase general circuit breaker panel boards (up to 16 amps), 12kW (up to 25 amps), 18kW (up to 32 amps) and 36kW (up to 63kW) have 3P+N+E female CETAC sockets for the connection of the required distribution panel boards, and can also be rented (up to 32 amps).

Notes:

The power consumption rates are likely to upgrade/modification.
Electricity and drive circuit consumption will be charged according to the POWER of the general circuit breaker panel boards installed.
Connection of stands to electrical supply will begin 4 days before the opening of the fair.
The rates indicated are subject.
The supply of power is a subcontracted service and FERIA VALENCIA cannot be responsible for power failures due to external circumstances

COMPULSORY MINIMUM REQUIREMENTS FOR STAND SUPPLY CONNECTION BASED ON SPANISH LEGISLATION

All electrical installations must be made with 1Kv. Conductor or in tubing, free from halogens and with reduced opacity.

CONDUCTORS

All electrical installations shall be made using electrical conductors rated at 1KV. (1000 V); mailing this 300, 500 and 750 V. Conductors may be used provided that they are enclosed within a protective tube ITC- BT 34, 6-2, 6-3, ITC- BT- 20, 2.2-1 and 2.2-2, ITC- BT-28.4. Conductors shall conform to the Spanish Standard UNE 21123-4 or 5, equivalent standard (ICE-502)
The minimum diameter of branch lines (for lighting and sockets) shall be 2.5mm, protected with heads with a maximum of 16 A. Joints and branches shall be protected using boxes.

PROTECTION

All installations shall be protected using a general 30 mA. differential. The chassis of all machinery and electrical equipment must be earthed. A general magnetothermal device rated in accordance with line intensity and general power consumption (conforming to international standards) must be used. Each branch line shall be protected by a magnetothermal device with a maximum of 16 A. and a minimum circuit-breaking capacity of 6 KA. (although 10 KA. is recommendable) (ITC-BT 34 3.1 and 3.3); failing this, ceramic cartridge fuses may be used with a maximum of 16 A., type (gl). (ITC-BT-022 1-1 a&b). Whatever the distribution plans used, the protection of installations for electrical equipment accessible to the general public must be equipped with devices with a maximum residual differential current of 30mA.

POWER POINT AND SOKETS

One single cable or Flex must be connected to one power point. Multiadaptors must not be used; multiple bases must not be used, except for mobile multiple bases connected to a fixed base with a flex measuring no longer than a maximum of 2m. (following standards ITC- BET 34-6, 4-4). All sockets will be earthed. The sockets installed in the ground will have appropriate protection against water leakages and will be installed at a distance of over one metre from any water outlet.

MOTORS

All motors with power exceeding 0.75 kilowatts must be equipped with a limited-intensity starting system, as established by current regulations (ITC-BT- 47-6).

LIGHTING

Lamps located less than 2.5 metres from the ground, or in places accessible to people, must be strongly fixed and located in such a way that they are not a risk for people and there is no risk of any materials setting on fire.
Any lighting which reaches high temperatures must be located far enough from any flammable materials.

EARTHED CONNECTIONS

The metallic structure of the stands must be earthed.

NEON SIGNS

Individual magnetothermal circuit breakers for each step-up transformer installed will be available.
Signs with their lower end at a distance less than 2.5 metres from the ground must be covered with an adequate dielectric cover.
Signs which are located higher than this must have all voltage areas insulated.

ELECTRICAL SYSTEM

The electricity supply must be a low power supply and must be set-up by a qualified installation company. Individuals or legal entities who wish to carry out such activities in Spain must submit a declaration with the requirements established by law to the corresponding body of the Autonomous Community in which they wish to settle. The corresponding body of the Autonomous Community will assign a company identification number. Once the electrical system has been set up, a qualified installation company will check the installation and will give the corresponding low voltage certificate (Certins page), a copy of which shall be given to the Electronic Services Department of Feria Valencia in order to connect the electricity supply.

2022**NOTES:**

Available to electrical installer at the FERIA VALENCIA Electrical Services Section is an abstract of the Low Voltage Electrotechnical Regulations BT and Regulation referring to high voltage lighting installations.

All electrical installations must be comply with the new standars (Real Decreto 842/2002 passed on 2 August 2002).

OBSERVATIONS:

FERIA VALENCIA has fixed power points with a maximum of 50KW for lighting and 35KW for machinery. All services must use these power points. In the event of needing power supply for machinery requiring more than 35 KW in one single power point, the Technical Services will indicate the exact point where it can be connected, with the applicant assuming the costs of supply and surge protector. Power points for lighting have a max of 18KW/ in a 5-pole 32A outlet. Exhibitors with lighting needing more power can fraction it and connect to the FERIA VALENCIA fixed power points. FERIA VALENCIA supplies a maximum electrical power of 3000W, single phase 230V.

All machines or device using electronic components which may be deprogrammed due to power cuts are compulsorily required to have UPS (Uninterrupted power supply) resides the necessary harmonic filters for disruptions and reactive power condensers, as regulated in the new ITC- BT-43 2.7 standards.

For power over 50kW in a single socket, and for each exhibitor, a project must be drawn-up by the contracted assembling company, and must be legalised in the PROP of Valencia's Regional Government (Generalitat Valenciana), and must be handed in at the Electronic Services Office of FERIA VALENCIA, together with the installation certificate. Certificates for the electrical connection delivered to the Electrical Services Department with less than four days before the opening the fair, will be subject to a minimum moratorium of eight hours for connection (prior validation that the electrical installation is correctly finalized).

IMPORTANT:

See application forms for electrical service power and lighting of Feria Valencia, on the supply of services offered exclusively by FERIA VALENCIA."

2022

TRADE FAIR:	
Exhibiting Firm:	
Contact:	Stand Number:
E-mail:	

The exhibitor must request, through the present document, the power and circuit breakers boxes for power/machinery required during the fair. Both services are supplied by Feria Valencia for all stands, up to 80Amps (40kw)
 Charges for protection boxes/circuit breakers boxes according to the power requested (All installations will be protected by 30mA differential):

RATES (VAT not included)

CIRCUIT BREAKERS BOXES - DIFFERENTIAL (CONTRACT REQUIRED) 400V, INCLUDES INSTALLATION CERTIFICATE	UNIT COST	UNITS
Power supply lines, 3-phase main electricity protection box. 7.5 kw (up to 16A)	91,00 €	
Power supply lines, 3-phase main electricity protection box. 10 kw (up to 20A)	115,00 €	
Power supply lines, 3-phase main electricity protection box. 15 kw (up to 32A)	145,00 €	
Power supply lines, 3-phase main electricity protection box. 24 kw (up to 50A)	235,00 €	
Power supply lines, 3-phase main electricity protection box. 30 kw (up to 63A)	300,00 €	
Power supply lines, 3-phase main electricity protection box. 40 kw (up to 80A)	380,00 €	

NOTE: The three-phase general circuit breaker panel boards have 3P+N+E female sockets for the connection and differential 30mA (See warnings at the end of this form)

PROTECTION BOXES / CIRCUIT BREAKERS FOR HIGH VOLTAGES (OPTIONAL)
 Protection boxes / circuit breakers boxes for high voltages are not included (request a quote):

- Design plan and installation completion certificate for this plan, both carried out by an approved technician. (Legally required)
- Power supply cables of over 40 metres in length
- Lifting machinery, etc., needed for connecting the lines.

PROTECTION BOXES / CIRCUIT BREAKERS FOR HIGH VOLTAGES (OPTIONAL)	UNIT COST	UNITS
Power supply lines, 3-phase main electricity protection box. 51 kw (400V, up to 100amps) and installation certificate.	724,00 €	
Power supply lines, 3-phase main electricity protection box. 60 kw (400V, up to 125amps) and installation certificate.	1.042,00 €	
Power supply lines, 3-phase main electricity protection box. 80 kw (400V, up to 160amps) and installation certificate.	1.168,00 €	
Power supply lines, 3-phase main electricity protection box. 125 kw (400V, up to 250amps) and installation certificate.	1.336,00 €	
Power supply lines, connection, and certification for a protection box for over 80 amps, property of the client.	In accordance with quote. Consumption depends on the total nominal power (see previous lists) of the protection boxes installed.	

Charges for electricity consumption will be charged to the exhibitor, according to the total power set up, which will be the sum of the power rating in the general circuit breakers boxes required:

1 day..... 6,28 €	2 days..... 9,20 €	3 days..... 11,76 €	4 days..... 11,76 €
5 days..... 11,76 €	6-7 days..... 12,55 €	8-9 days..... 14,07 €	

The closing date for contracting these services is one month prior to start of the fair. FERIA VALENCIA reserves the right to reject any applications received after the said date.

DEADLINE FOR SENDING THIS FORM: 1 MONTH BEFORE SET-UP. ANY APPLICATION RECEIVED WITH LESS THAN 4 WORKING DAYS BEFORE THE START OF SET UP, WILL IMPLY A 25% SURCHARGE ON THE TOTAL RATE. AVAILABILITY OF ALL REFERENCES IS NOT GUARANTEED. PLEASE SEND THIS FORM BY E-MAIL: servicecenter@feriavalencia.com

Date, signature, and company stamp

ADDITIONAL CETAC SOCKETS (FOR SALE)	UNIT COST
10/16 Amp 2P + T Plug	3,50 €
32-Amp plug 3P+N+T	9,00 €
63-Amp plug 3P+N+T	44,40 €

2022**DESIGN PLANS WITH INSTALLATION COMPLETION CERTIFICATES**

In accordance with Spanish legislation, all stands with an electrical power outlet of more than 50 kw need to have a technical design and installation certificate, carried out by a competent technician.

If each individual power outlet does not exceed 50 kw, then this plan will not be necessary.

FEES for carrying out the design plan with installation completion certification (including VAT):

- Up to 100 kw of total power installed in protection boxes at the stand: 841,00 €
- Over 100 kw of total power installed in protection boxes at the stand: 1.261,00 €

DEADLINE FOR SENDING THIS FORM: 1 MONTH BEFORE SET-UP. ANY APPLICATION RECEIVED WITH LESS THAN 4 WORKING DAYS BEFORE THE START OF SET UP, WILL IMPLY A 25% SURCHARGE ON THE TOTAL RATE. AVAILABILITY OF ALL REFERENCES IS NOT GUARANTEED. PLEASE SEND THIS FORM BY E-MAIL: servicecenter@feriavalencia.com

Date, signature, and company stamp

2022**IMPORTANT:**

In order for the correct setting up of the panel boards, a plan of their location (with the limits given in centimetres) must be sent a month before the start of the exhibition to the following this email: servicecenter@feriavalencia.com.
On the plan, the walls of the stand must be labelled with "neighbour" or "corridor" so that the plan can be correctly read. Please note that the service entrance is normally done via outlet boxes found on the floor and so the outlet boxes or panel boards used for the stand must be accessible at all times and must not be covered by any platforms or other surfaces which cannot be easily and immediately removed.

SERVICE CONDITIONS:

- In case of cancellation of a service one month prior to the start of an exhibition, 25% of the corresponding charge must be paid.
- Any change or cancellation made to a service which has already been contracted, and which has already been rendered or set up, must be paid entirely and a new charge for the new service contracted will apply.
- The service entrance and general circuit breaker panel boards, according to the application sent, are included.
- The electrical certification of the stand emitted by the contracted assembling company is included.
- The service is a rental service and so any damages, loss or anomaly in the equipment will always be charged to the assembling company.
- The electricity supply for the stand other than that of the general circuit breaker panel board is not included.
- The differential protection for all the general circuit breaker panel boards has a sensitivity of 30mA, as established by the Low Power Electromagnetic Regulations (R.E.B.T. in Spanish, Royal Decree 842/2002) and the Additional Technical Instructions (see legally binding regulations annex for the electricity supply in Feria Valencia).
- Each general circuit breaker panel board has a Schuko single-phase base, of up to 16 amps, for the assembly of the stand. The final electricity connection to the stands will start 4 days before the start of the fair, provided that the electricity supply for the stand has been set up and that the certification is positive, according to the R.E.B.T. regulations, the Additional Technical Instructions and the Feria Valencia regulations.
- The 9kW, three-phase general circuit breaker panel boards (up to 16 amps), 12kW (up to 25 amps), 18kW (up to 32 amps) and 36kW (up to 63kW) have 3P+N+E female CETAC sockets for the connection of the required distribution panel boards, and can also be rented (up to 32 amps).

Notes:

The power consumption rates are likely to upgrade/modification.

Electricity and drive circuit consumption will be charged according to the POWER of the general circuit breaker panel boards installed. Connection of stands to electrical supply will begin 4 days before the opening of the fair.

The rates indicated are subject.

The supply of power is a subcontracted service and FERIA VALENCIA cannot be responsible for power failures due to external circumstances

COMPULSORY MINIMUM REQUIREMENTS FOR STAND SUPPLY CONNECTION BASED ON SPANISH LEGISLATION

All electrical installations must be made with 1Kv. Conductor or in tubing, free from halogens and with reduced opacity.

CONDUCTORS

All electrical installations shall be made using electrical conductors rated at 1KV. (1000 V); mailing this 300, 500 and 750 V. Conductors may be used provided that they are enclosed within a protective tube ITC- BT 34, 6-2, 6-3, ITC- BT- 20, 2.2-1 and 2.2-2, ITC- BT-28.4. Conductors shall conform to the Spanish Standard UNE 21123-4 or 5, equivalent standard (ICE-502)

The minimum diameter of branch lines (for lighting and sockets) shall be 2.5mm, protected with heads with a maximum of 16 A. Joints and branches shall be protected using boxes.

PROTECTION

All installations shall be protected using a general 30 mA. differential. The chassis of all machinery and electrical equipment must be earthed. A general magnetothermal device rated in accordance with line intensity and general power consumption (conforming to international standards) must be used. Each branch line shall be protected by a magnetothermal device with a maximum of 16 A. and a minimum circuit-breaking capacity of 6 KA. (although 10 KA. is recommendable) (ITC-BT 34 3.1 and 3.3); failing this, ceramic cartridge fuses may be used with a maximum of 16 A., type (gl). (ITC-BT-022 1-1 a&b). Whatever the distribution plans used, the protection of installations for electrical equipment accessible to the general public must be equipped with devices with a maximum residual differential current of 30mA.

POWER POINT AND SOKETS

All sockets will be earthed. The sockets installed in the ground will have appropriate protection against water leakages and will be installed at a distance of over one metre from any water outlet.

MOTORS

All motors with power exceeding 0.75 kilowatts must be equipped with a limited-intensity starting system, as established by current regulations (ITC-BT- 47-6).

LIGHTING

Lamps located less than 2.5 metres from the ground, or in places accessible to people, must be strongly fixed and located in such a way that they are not a risk for people and there is no risk of any materials setting on fire.

Any lighting which reaches high temperatures must be located far enough from any flammable materials.

EARTHED CONNECTIONS

The metallic structure of the stands must be earthed.

NEON SIGNS

Individual magnetothermal circuit breakers for each step-up transformer installed will be available.

Signs with their lower end at a distance less than 2.5 metres from the ground must be covered with an adequate dielectric cover. Signs which are located higher than this must have all voltage areas insulated.

ELECTRICAL SYSTEM

The electricity supply must be a low power supply and must be set-up by a qualified installation company. Individuals or legal entities who wish to carry out such activities in Spain must submit a declaration with the requirements established by law to the corresponding body of the Autonomous Community in which they wish to settle. The corresponding body of the Autonomous Community will assign a company identification number. Once the electrical system has been set up, a qualified installation company will check the installation and will give the corresponding low voltage certificate (Certins page), a copy of which shall be given to the Electronic Services Department of Feria Valencia in order to connect the electricity supply.

APPLICATION FORM

NOTES:

Available to electrical installer at the FERIA VALENCIA Electrical Services Section is an abstract of the Low Voltage Electrotechnical Regulations BT and Regulation referring to high voltage lighting installations.

All electrical installations must be comply with the new standards (Real Decreto 842/2002 passed on 2 August 2002).

2022

OBSERVATIONS:

FERIA VALENCIA has fixed power points with a maximum of 50KW for lighting and 35KW for machinery. All services must use these power points. In the event of needing power supply for machinery requiring more than 35 KW in one single power point, the Technical Services will indicate the exact point where it can be connected, with the applicant assuming the costs of supply and surge protector. Power points for lighting have a max of 18KW/ in a 5-pole 32A outlet. Exhibitors with lighting needing more power can fraction it and connect to the FERIA VALENCIA fixed power points. FERIA VALENCIA supplies a maximum electrical power of 3000W, single phase 230V.

All machines or device using electronic components which may be deprogrammed due to power cuts are compulsorily required to have UPS (Uninterrupted power supply) resides the necessary harmonic filters for disruptions and reactive power condensers, as regulated in the new ITC- BT-43 2.7 standards.

DESIGN PLAN FOR POWER OUTLETS OF MORE THAN 50 KW

In accordance with Spanish legislation, all stands with an electrical power outlet of more than 50 kw need to have a design plan and installation certificate, carried out by a competent technician (an engineer with expertise in electrotechnics).

If each individual power outlet does not exceed 50 kw, then this plan will not be necessary.

For example, a stand with a lighting outlet of 30 kw and two power outlets of 40 kw, amounting to 110 kw in total, will not need a design plan; a stand with a power outlet of 80 kw a lighting outlet of 30 kw, also amounting to 110 kw in total, will need a design plan.

The data required to carry out the plan will be (see Feria Valencia's regulations on electrical installations):

Owner's details (name, company name, address, Tax ID No.).

Installer's details (name, company name, address, Tax ID No.).

Stand location.

Nominal ratio and power of receivers being installed, along with stand floor plan showing their location.

Security systems and devices employed, distribution and protection boxes, etc.

Schematic diagram of the installation, characteristics of circuit-breaker and protection devices employed, points of use and conductor sections.

Characteristics and conductor sections and conduits to be used.

Sketch of the layout, indicating the location of the different points of use.

Calculations supporting the design, if available.

Technical Plan (Power)

10C

APPLICATION FORM

2022

TRADE FAIR:

Exhibiting Firm:

Contact:

Stand Number:

E-mail:

DRAW THE TECHNICAL PLAN OF THE STAND HERE

The plan **MUST** be sent. If it is not received, the location of the services will be up to FERIA VALENCIA, with no possibility of further changes during the assembly of the stand.

DEADLINE FOR SENDING THIS FORM: 1 MONTH BEFORE SET-UP.
PLEASE SEND THIS FORM BY E-MAIL: servicecenter@feriavalencia.com

Date, signature, and company stamp

Date: Valencia, / / 202 ...



2022

DETAILS OF COMPANY APPLYING

NAME:	
Company reg:	Nº:
Postal address:	
Person in Charge/Responsible for Build-up:	Job Title/Position:
Tel:	E-mail:

INVOICING DETAILS: (provide only if different from details given above)

NAME:	
Company reg:	Nº:
Postal address:	
Person in Charge/Responsible for Build-up:	Job Title/Position:
Tel:	E-mail:

Basic details of the elements to be hung from the building's structure:

COMPANY:	
Stand Nº :	Location:
EXHIBITION:	

Nº of HANGING POINTS ON THE BUILDING'S STRUCTURE:	
---	--

TOTAL WEIGHT TO BE HUNG	
-------------------------	--

INDICATE ESTIMATED DATE TO LIFT THE STRUCTURE:	
--	--

Indicate if these are TYPE A or TYPE B structures

TYPE A

These are structures comprised of *standard aluminium structural elements* (TRUSS) *either bare or covered in non-flammable cloth* from which individual elements will be hung such as spotlights or banners of known, specific weights

TYPE B

These are all structures that cannot be classified as Type A, such as *carpentry ceilings or wood-covered truss structures*.

**DEADLINE FOR SENDING THIS FORM: 1 MONTH BEFORE SET-UP, ANY APPLICATION RECEIVED WITH LESS DAYS BEFORE THE START OF SET UP, WILL IMPLY A 25% SURCHARGE ON THE TOTAL RATE DURING THE ASSEMBLY AVAILABILITY OF ALL REFERENCES IS NOT GUARANTEED AND THE SERVICE WILL BE PROVIDED BY SEPARATE QUOTATION
PLEASE SEND THIS FORM BY EMAIL: servicecenter@feriavalencia.com**

Date, signature, and company stamp

2022

INFORMATION/DOCUMENTATION TO BE SUPPLIED BY THE COMPANY APPLYING

The company applying is **RESPONSIBLE** for the truth of the details provided both in the present application form and in the attached documents such as designs, hanging specifications and, particularly, everything relating to the weight and dimensions of every one of the system's elements. Authorisation of the present application will under no circumstances imply that FERIA VALENCIA or its partners in this service will accept any responsibility for the structural solution planned.

For TYPE A structures: The company applying must provide the following documents to rigging@feriavalencia.com

TO BE COMPLETED BY:	to be provided by INSPECTION COMPANY	to be provided by STAND BUILDER
PROJECT: The exact location of the stand must be detailed and the main elements to be used must be described, both the principal structural elements and the elements that are to be hung from them.	YES <input type="checkbox"/> NO <input type="checkbox"/>	YES <input type="checkbox"/> NO <input type="checkbox"/>
List of weights of all the elements comprising the structure	YES <input type="checkbox"/> NO <input type="checkbox"/>	YES <input type="checkbox"/> NO <input type="checkbox"/>
Number of rigging points being requested , including a numbered table showing the calculated and proven weight that each rigging point will bear.	YES <input type="checkbox"/> NO <input type="checkbox"/>	YES <input type="checkbox"/> NO <input type="checkbox"/>
Scale diagrams showing floor elevation measurements of the installation , with a precise indication and identification of each rigging point and of the location of the structural elements and what is intended to be hung from each one. The location and orientation of the stand relative to the pavilion building must be clearly indicated, for example by showing the numbers of the stands adjacent to each façade and whether the façade is on an aisle.	YES <input type="checkbox"/> NO <input type="checkbox"/>	YES <input type="checkbox"/> NO <input type="checkbox"/>
List of the materials that will be used for structural purposes (TRUSS) and their technical specifications ; quality certificates and EU standardisation certificates for the elements listed must be provided.	YES <input type="checkbox"/> NO <input type="checkbox"/>	YES <input type="checkbox"/> NO <input type="checkbox"/>
Description of how it is intended to attach the safety system	YES <input type="checkbox"/> NO <input type="checkbox"/>	YES <input type="checkbox"/> NO <input type="checkbox"/>

DEADLINE FOR SENDING THIS FORM: 1 MONTH BEFORE SET-UP, ANY APPLICATION RECEIVED WITH LESS DAYS BEFORE THE START OF SET UP, WILL IMPLY A 25% SURCHARGE ON THE TOTAL RATE DURING THE ASSEMBLY AVAILABILITY OF ALL REFERENCES IS NOT GUARANTEED AND THE SERVICE WILL BE PROVIDED BY SEPARATE QUOTATION
 PLEASE SEND THIS FORM BY EMAIL: servicecenter@feriavalencia.com

Date, signature, and company stamp

Application for Permission to Hang Rigging

11A

APPLICATION FORM

2022

For TYPE B structures: The company applying must provide the same documents as required for TYPE A structures (See TYPE A paragraph) along with the following, complementary documents, to rigging@feriavalencia.com

TO BE COMPLETED BY:	to be provided by INSPECTION COMPANY	to be provided by STAND BUILDER
A written description of the project drafted by a competent specialist. This document must describe and provide full proof of the structural safety of the elements to be hung, to the same level of detail as that of construction plans. A 'competent specialist' is understood to be a practitioner who has trained and holds sufficient qualifications in structural design: an Architect, Structural Engineer, Engineer or Technical Engineer. Technical qualifications will only be accepted from European Union member countries. Special attention must be paid to the technical and construction details in the description of the principal rigging points and of the safety cables, which must be different and independent of each other.	YES <input type="checkbox"/> NO <input type="checkbox"/>	YES <input type="checkbox"/> NO <input type="checkbox"/>
Valid Civil Liability insurance policy covering the technical author of the project, plus photocopy of latest receipt of payment.	YES <input type="checkbox"/> NO <input type="checkbox"/>	YES <input type="checkbox"/> NO <input type="checkbox"/>
Certificate of completion of installation: it is compulsory that prior to the structure being raised the technician who has drafted the brief send a completion of installation certificate, guaranteeing that the structure is safe and has been completed as specified in the brief, to the following e-mail address: rigging@feriavalencia.com	YES <input type="checkbox"/> NO <input type="checkbox"/>	YES <input type="checkbox"/> NO <input type="checkbox"/>

INSPECTION COMPANY (to be completed by the inspection company)		
CHECK OF THE ASSEMBLY	YES <input type="checkbox"/>	NO <input type="checkbox"/>
Is the assembly as specified in the approved brief	YES <input type="checkbox"/>	NO <input type="checkbox"/>
Have any modifications been necessary	YES <input type="checkbox"/>	NO <input type="checkbox"/>
Has the safety system been put in place	YES <input type="checkbox"/>	NO <input type="checkbox"/>

Signed, Person in charge, Installation Contractor

Signed, Inspection Company (Project Check)

Signed, Inspection Company (Assembly Inspection & Check)

DEADLINE FOR SENDING THIS FORM: 1 MONTH BEFORE SET-UP, ANY APPLICATION RECEIVED WITH LESS DAYS BEFORE THE START OF SET UP, WILL IMPLY A 25% SURCHARGE ON THE TOTAL RATE DURING THE ASSEMBLY AVAILABILITY OF ALL REFERENCES IS NOT GUARANTEED AND THE SERVICE WILL BE PROVIDED BY SEPARATE QUOTATION
PLEASE SEND THIS FORM BY EMAIL: servicecenter@feriavalencia.com

Date, signature, and company stamp

2022

PRICES - RIGGING SERVICES

RATES (VAT not included)

Nº POINTS	PRICE /UNIT	ADMINISTRATIVE TAXES UNIT.	CERTIFICATE TAXES UNIT.	TOTAL PRICE/UNIT.	QUANTITY POINTS
1	210,20 €	+ 22 €	+ 30,80 €	= 263,00 €	
2	180,20 €	+ 22 €	+ 30,80 €	= 233,00 €	
3	170,20 €	+ 22 €	+ 30,80 €	= 223,00 €	
4	165,20 €	+ 22 €	+ 30,80 €	= 218,00 €	
5	162,20 €	+ 22 €	+ 30,80 €	= 215,00 €	
6 a 10	159,20 €	+ 22 €	+ 30,80 €	= 212,00 €	
11 a 30	159,20 €	+ 22 €	+ 28,60 €	= 209,80 €	
31 a 50	159,20 €	+ 22 €	+ 25,30 €	= 206,50 €	
+ de 50	159,20 €	+ 22 €	+ 20,90 €	= 202,10 €	

ACCESORIES FOR SIMPLE RIGGING POINTS

ITEM	PRICE UNIT	QUANTITY	TOTAL
MOTOR HOIST:	125€		

CONTACT DETAILS, PARTNER SUPPLIERS:

Should you require the necessary reports/briefs/specifications to be drafted for you, the following companies are Feria Valencia partners and can provide these services:

- REPORT DRAFTING - TYPE A structures:

SGS TECNOS, S.A: Gerardo Burgos
e-mail: gerardo.burgos@sgs.com

- DRAFTING OF TECHNICAL SPECIFICATIONS - TYPE B structures:

SGS TECNOS, S.A: Gerardo Burgos
e-mail: gerardo.burgos@sgs.com

MARSAN INGENIEROS, SL: Tel. contacto: +34 96 362 45 04
e-mail: comercial@marsaningenieros.es

TERMS AND CONDITIONS

1. Feria Valencia will manage the siting of the anchor points on the ceiling for reasons of safety, risk prevention and maintenance of the building.
2. Exhibitors or stand builders may install their own truss provided they have sent the certificates of conformity to Feria Valencia in advance and these have been accredited and approved by the inspection company, SGS.
3. The Price of the accessory includes installation, handling and removal.
4. Where a structural unit has more than 6 rigging points before it is lifted into position, the applicant will have to use ELECTRICAL (NOT MANUAL) HOISTS and PULLEYS, which it must hire through Feria Valencia. In addition, it must be borne in mind that two units that are structurally different on the ground may NOT be joined together structurally once they have been raised.

DEADLINE FOR SENDING THIS FORM: 1 MONTH BEFORE SET-UP, ANY APPLICATION RECEIVED WITH LESS DAYS BEFORE THE START OF SET UP, WILL IMPLY A 25% SURCHARGE ON THE TOTAL RATE DURING THE ASSEMBLY AVAILABILITY OF ALL REFERENCES IS NOT GUARANTEED AND THE SERVICE WILL BE PROVIDED BY SEPARATE QUOTATION
PLEASE SEND THIS FORM BY EMAIL: servicecenter@feriavalencia.com

Date, signature, and company stamp

2022

TRADE FAIR:

Exhibiting Firm:

Contact:

Stand Number:

E-mail:

Person in Charge of Assembly:

Phone:

RATES (VAT not included)

TYPE OF TRUSS	METERS	PRICE MT.	TOTAL
<input type="checkbox"/> SQUARE TRUSS OF 30 CM X 30 CM		25,00 €	
<input type="checkbox"/> TRIANGULAR TRUSS OF 25 CM X 25 CM		25,00 €	
<input type="checkbox"/> CIRCLE TRUSS/ PLEASE TYPE DIAMETER		request budget	

WEIGHT AND HEAVY

1. TOTAL WEIGHT OF ITEMS ON TRUSS: 2. THERE IS HEAVY ITEM IN ANY POINT WITH WEIGHT:

If there is a heavy weight in any point at B.2 blank, please include in your information the location of this heavy weight.

TERMS & CONDITIONS

1. The amount of truss includes to assembly it and remove it.
2. The customer becomes person in charge of the flaw caused to the items in rent.

DEADLINE FOR SENDING THIS FORM: 1 MONTH BEFORE SET-UP, ANY APPLICATION RECEIVED WITH LESS DAYS BEFORE THE START OF SET UP, WILL IMPLY A 25% SURCHARGE ON THE TOTAL RATE DURING THE ASSEMBLY AVAILABILITY OF ALL REFERENCES IS NOT GUARANTEED AND THE SERVICE WILL BE PROVIDED BY SEPARATE QUOTATION
PLEASE SEND THIS FORM BY EMAIL: servicecenter@feriavalencia.com

Date, signature, and company stamp

Date: Valencia, / / 202.....



2022

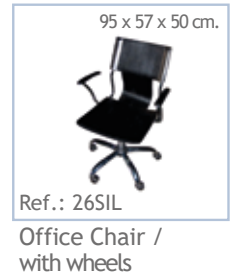

12 Furniture and Complementary Accessories Rental

2022

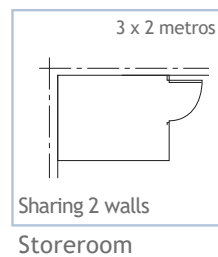
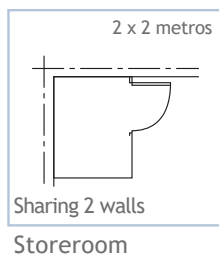
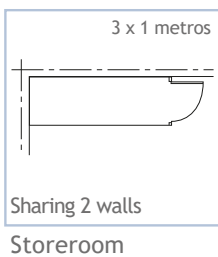
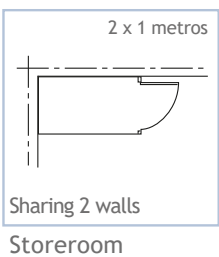
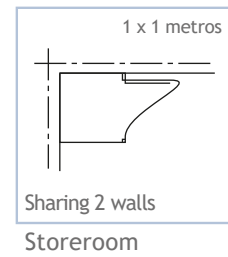
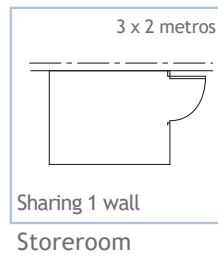
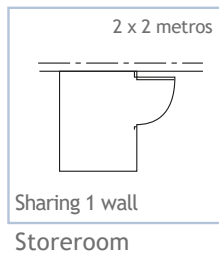
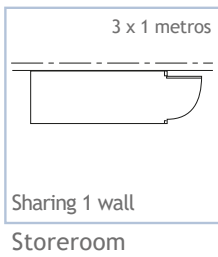
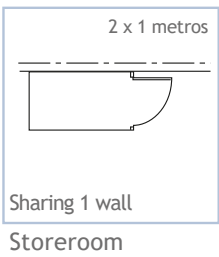
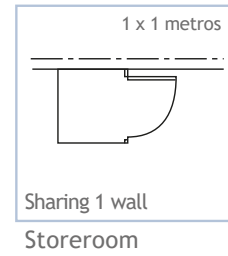
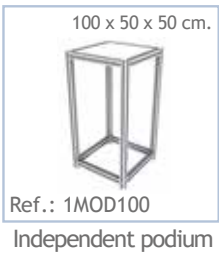

2022

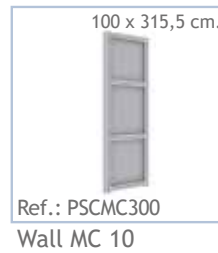

The plan **MUST** be sent. If it is not received, the location of the services will be up to FERIA VALENCIA, with no possibility of further changes during the assembly of the stand.

Furniture and Complementary Accessories Rental 12A

APPLICATION FORM

2022

TRADE FAIR:













Exhibiting Firm:

Contact:

Stand Number:

E-mail:

PACKS

					
Ref.: PACK01	Ref.: PACK02	Ref.: PACK03	Ref.: PACK04	Ref.: PACK05	Ref.: PACK06
					
Ref.: PACK07	Ref.: PACK08	Ref.: PACK09	Ref.: PACK10	Ref.: PACK11	Ref.: PACK12

TARIFAS (IVA no incluido)

DESCRIPTION	QUANTITY	EUROS / UNIT	TOTAL EUROS
<input type="checkbox"/> Ref.: PACK01 4 Director Chairs - Marte Table		86,00	
<input type="checkbox"/> Ref.: PACK02 4 Confy Chairs - Marte Table		126,00	
<input type="checkbox"/> Ref.: PACK03 4 Cubiña Chairs - Marte Table		188,00	
<input type="checkbox"/> Ref.: PACK04 4 Hami Chairs - Marte Table		105,00	
<input type="checkbox"/> Ref.: PACK05 3 Cubiña Chairs - Marte Office Table - Drawer		170,00	
<input type="checkbox"/> Ref.: PACK06 3 Eyna Chairs - Marte Office Table - Drawer		222,00	
<input type="checkbox"/> Ref.: PACK07 Cubic Stool - Counter		121,00	
<input type="checkbox"/> Ref.: PACK08 Cubic Stool - Showcase Counter		164,00	
<input type="checkbox"/> Ref.: PACK09 Cubic Stool - MC45 Counter		159,00	
<input type="checkbox"/> Ref.: PACK10_01 4 Pvc anatomical White Chairs - Marte Office Table		214,00	
<input type="checkbox"/> Ref.: PACK10_02 4 Pvc anatomical Black Chairs - Marte Office Table		214,00	
<input type="checkbox"/> Ref.: PACK10_03 4 Pvc anatomical Silver Chairs - Marte Office Table		214,00	
<input type="checkbox"/> Ref.: PACK11_01 3 Pvc anatomical Chairs - Adjustable Table / White		183,00	
<input type="checkbox"/> Ref.: PACK11_02 3 Pvc anatomical Chairs - Adjustable Table / Black		183,00	
<input type="checkbox"/> Ref.: PACK11_03 3 Pvc anatomical Chairs - Adjustable Table / Silver		183,00	
<input type="checkbox"/> Ref.: PACK12_02 3 Pvc adjustable Stools - Adjustable Table / Black		200,00	
<input type="checkbox"/> Ref.: PACK12_03 3 Pvc adjustable Stools - Adjustable Table / Silver		200,00	

DEADLINE FOR SENDING THIS FORM: 4 WORKING DAYS BEFORE SET-UP. ANY APPLICATION RECEIVED WITH LESS THAN 4 WORKING DAYS BEFORE THE START OF SET UP, WILL IMPLY A 25% SURCHARGE ON THE TOTAL RATE. AVAILABILITY OF ALL REFERENCES IS NOT GUARANTEED. PLEASE SEND THIS FORM BY EMAIL: servicecenter@feriavalencia.com

Date, signature, and company stamp

Date: Valencia, / / 202....

Furniture and Complementary Accessories Rental 12B

APPLICATION FORM

2022

TRADE FAIR:

Exhibiting Firm:

Contact:

Stand Number:

E-mail:

CHAIRS / STOOLS

RATES (VAT not included)

DESCRIPTION	QUANTITY	EUROS / UNIT	TOTAL EUROS
<input type="checkbox"/> Ref.: 1SIL Director Chair / Black metallic - Linen		12,00	
<input type="checkbox"/> Ref.: 7SIL Confy Chair / Metallic - Blue textile		19,00	
<input type="checkbox"/> Ref.: 9SIL Cubiña-N Chair / Natural wood		39,00	
<input type="checkbox"/> Ref.: 10SIL Cubiña-T Chair / Stained wood		39,00	
<input type="checkbox"/> Ref.: 12SIL Eyna Chair / Light gray polypropylene		51,00	
<input type="checkbox"/> Ref.: 19SIL Hami Chair / Gray metal folding chair		16,00	
<input type="checkbox"/> Ref.: 20SIL01 Pvc anatomical Chair/ White		48,00	
<input type="checkbox"/> Ref.: 20SIL02 Pvc anatomical Chair / Black		48,00	
<input type="checkbox"/> Ref.: 20SIL03 Pvc anatomical Chair/ Silver		48,00	
<input type="checkbox"/> Ref.: 21SIL Fibre frame Chair/ White - Metallic legs		62,00	
<input type="checkbox"/> Ref.: 24SIL Linus Chair / White - Pvc		26,00	
<input type="checkbox"/> Ref.: 25SIL Vulcano Chair		26,00	
<input type="checkbox"/> Ref.: 26SIL Office Chair with wheels		60,00	
<input type="checkbox"/> Ref.: 9TAB Cubic Walnut Stool / Metallic		43,00	
<input type="checkbox"/> Ref.: 10TAB Cubic Beech Stool / Metallic		43,00	
<input type="checkbox"/> Ref.: 11TAB02 Pvc adjustable Stool / Black		55,00	
<input type="checkbox"/> Ref.: 11TAB03 Pvc adjustable Stool / Silver		55,00	
<input type="checkbox"/> Ref.: 15TAB Marte Stool / Wenge wood seat-Chrome		43,00	

DEADLINE FOR SENDING THIS FORM: 4 WORKING DAYS BEFORE SET-UP. ANY APPLICATION RECEIVED WITH LESS THAN 4 WORKING DAYS BEFORE THE START OF SET UP, WILL IMPLY A 25% SURCHARGE ON THE TOTAL RATE. AVAILABILITY OF ALL REFERENCES IS NOT GUARANTEED. PLEASE SEND THIS FORM BY EMAIL: servicecenter@feriavalencia.com

Date, signature, and company stamp

Date: Valencia, / / 202....

Furniture and Complementary Accessories Rental **12C**

APPLICATION FORM

2022

TRADE FAIR:

Exhibiting Firm:

Contact:

Stand Number:

E-mail:

TABLES

RATES (VAT not included)

DESCRIPTION	QUANTITY	EUROS / UNIT	TOTAL EUROS
<input type="checkbox"/> Ref.: 4MES Marte melamine Table / Round table		37,00	
<input type="checkbox"/> Ref.: 20MES Marte chromed Table / Glass top acid		54,00	
<input type="checkbox"/> Ref.: 22MES Marte office Table / Rectangular glass top		57,00	
<input type="checkbox"/> Ref.: 27MES Marte low Table / Round glass top acid		37,00	
<input type="checkbox"/> Ref.: 28MES Marte high Table / Round glass top acid		59,00	
<input type="checkbox"/> Ref.: 30MES Marte square Table / Square glass top		41,00	
<input type="checkbox"/> Ref.: 24MES Cubic Beech Table / Hight colour Titan		53,00	
<input type="checkbox"/> Ref.: 26MES02 Pvc Table, adjustable height / Black		69,00	
<input type="checkbox"/> Ref.: 26MES03 Pvc Table, adjustable height / Silver		69,00	
<input type="checkbox"/> Ref.: 31MES Office Table / Melamine Top		42,00	
<input type="checkbox"/> Ref.: 5ARM Aluminum Wardrobe / Beech 1 shelves		41,00	
<input type="checkbox"/> Ref.: 6ARM Aluminum Wardrobe / Beech 2 shelves		53,00	
<input type="checkbox"/> Ref.: 3CAJ Melamine Drawer Aluminum - Beech		28,00	

PODIUMS / COUNTERS

RATES (VAT not included)

DESCRIPTION	QUANTITY	EUROS / UNIT	TOTAL EUROS
<input type="checkbox"/> Ref.: 1MOD100 Independent podium with top		43,00	
<input type="checkbox"/> Ref.: 2MOD075 Independent podium with top		38,00	
<input type="checkbox"/> Ref.: 3MOD050 Independent podium with top		32,00	
<input type="checkbox"/> Ref.: 4MOD025 Independent podium with top		25,00	
<input type="checkbox"/> Ref.: 6MOD200 Bookshelf 2 metres / 4 Shelves		100,00	
<input type="checkbox"/> Ref.: 1MOSTRAD Straight Aluminum Counter-Melamine		92,00	
<input type="checkbox"/> Ref.: 2MOSTRAD Showcase Counter		129,00	
<input type="checkbox"/> Ref.: MOSMC45 Counter in MC-45		139,00	

DEADLINE FOR SENDING THIS FORM: 4 WORKING DAYS BEFORE SET-UP. ANY APPLICATION RECEIVED WITH LESS THAN 4 WORKING DAYS BEFORE THE START OF SET UP, WILL IMPLY A 25% SURCHARGE ON THE TOTAL RATE. AVAILABILITY OF ALL REFERENCES IS NOT GUARANTEED. PLEASE SEND THIS FORM BY EMAIL: servicecenter@feriavalencia.com

Date, signature, and company stamp

Date: Valencia, / / 202....

Furniture and Complementary Accessories Rental 12D

APPLICATION FORM

2022

TRADE FAIR:

Exhibiting Firm:

Contact:

Stand Number:

E-mail:

SOFAS / COUCHES / PUFFS

RATES (VAT not included)

DESCRIPTION	QUANTITY	EUROS / UNIT	TOTAL EUROS
<input type="checkbox"/> Ref.: 2SOFA01 Sofa 2 seats and chromed arms/Cream		235,00	
<input type="checkbox"/> Ref.: 2SOFA02 Sofa 2 seats and chromed arms/Black		235,00	
<input type="checkbox"/> Ref.: 2SOFA03 Sofa 2 seats and chromed arms/Red		235,00	
<input type="checkbox"/> Ref.: 3SON Bubble Couch / 1 Seat white polyurethane		96,00	
<input type="checkbox"/> Ref.: 4SON01 Couch 1 seat and chromed arms/Cream		178,00	
<input type="checkbox"/> Ref.: 4SON02 Couch 1 seat and chromed arms/Black		178,00	
<input type="checkbox"/> Ref.: 4SON03 Couch 1 seat and chromed arms/Red		178,00	
<input type="checkbox"/> Ref.: 1PUFF01 Cream Puff 50x55 cms.		80,00	
<input type="checkbox"/> Ref.: 1PUFF02 Black Puff 50x55 cms.		80,00	

ACCESSORIES

RATES (VAT not included)

DESCRIPTION	QUANTITY	EUROS / UNIT	TOTAL EUROS
<input type="checkbox"/> Ref.: LID005 PVC Canvas S/Digital printing		34,50	
<input type="checkbox"/> Ref.: LMP003 Microperforated Canvas digital printing		34,50	
<input type="checkbox"/> Ref.: LOGOD100 vinyl in digital printing (on melamine panel per sqm)		41,00	
<input type="checkbox"/> Ref.: LOGOV100 vinyl in digital printing (on chipboard panel per sqm)		47,00	
<input type="checkbox"/> Ref.: 5PER Medias Lunas Clothes stand		41,00	
<input type="checkbox"/> Ref.: 1PAP Plastic wastepaper basket		12,00	
<input type="checkbox"/> Ref.: LOGO UP TO 1 linear metre of vinyl		57,00	

DEADLINE FOR SENDING THIS FORM: 4 WORKING DAYS BEFORE SET-UP. ANY APPLICATION RECEIVED WITH LESS THAN 4 WORKING DAYS BEFORE THE START OF SET UP, WILL IMPLY A 25% SURCHARGE ON THE TOTAL RATE. AVAILABILITY OF ALL REFERENCES IS NOT GUARANTEED. PLEASE SEND THIS FORM BY EMAIL: servicecenter@feriavalencia.com

Date, signature, and company stamp

Date: Valencia, / / 202....

Furniture and Complementary Accessories Rental **12E**

APPLICATION FORM

2022

TRADE FAIR:	
Exhibiting Firm:	
Contact:	Stand Number:
E-mail:	

STOREROOMS

RATES (VAT not included)

DESCRIPTION	QUANTITY	EUROS / UNIT	TOTAL EUROS
CHIBOARD STOREROOM			
<input type="checkbox"/> Ref.: ALMA1M01 Painted chipboard Storeroom/Sharing 1 wall 1x1		356,00	
<input type="checkbox"/> Ref.: ALMA1M02 Painted chipboard Storeroom/Sharing 1 wall 2x1		456,00	
<input type="checkbox"/> Ref.: ALMA1M03 Painted chipboard Storeroom/Sharing 1 wall 3x1		555,00	
<input type="checkbox"/> Ref.: ALMA1M04 Painted chipboard Storeroom/Sharing 1 wall 2x2		655,00	
<input type="checkbox"/> Ref.: ALMA1M05 Painted chipboard Storeroom/Sharing 1 wall 3x2		854,00	
<input type="checkbox"/> Ref.: ALMA2M01 Painted chipboard Storeroom/Sharing 2 walls 1x1		257,00	
<input type="checkbox"/> Ref.: ALMA2M02 Painted chipboard Storeroom/Sharing 2 walls 2x1		346,00	
<input type="checkbox"/> Ref.: ALMA2M03 Painted chipboard Storeroom/Sharing 2 walls 3x1		456,00	
<input type="checkbox"/> Ref.: ALMA2M04 Painted chipboard Storeroom/Sharing 2 walls 2x2		465,00	
<input type="checkbox"/> Ref.: ALMA2M05 Painted chipboard Storeroom/Sharing 2 walls 3x2		555,00	
STOREROOM MC10 - OCT			
<input type="checkbox"/> Ref.: ALMC1M01 MC-10 Storeroom Sharing 1 wall 1x1		159,00	
<input type="checkbox"/> Ref.: ALMC1M02 MC-10 Storeroom Sharing 1 wall 2x1		207,00	
<input type="checkbox"/> Ref.: ALMC1M03 MC-10 Storeroom Sharing 1 wall 3x1		255,00	
<input type="checkbox"/> Ref.: ALMC1M04 MC-10 Storeroom Sharing 1 wall 2x2		303,00	
<input type="checkbox"/> Ref.: ALMC1M05 MC-10 Storeroom Sharing 1 wall 3x2		352,00	
<input type="checkbox"/> Ref.: ALMC2M01 MC-10 Storeroom Sharing 2 walls 1x1		111,00	
<input type="checkbox"/> Ref.: ALMC2M02 MC-10 Storeroom Sharing 2 walls 2x1		159,00	
<input type="checkbox"/> Ref.: ALMC2M03 MC-10 Storeroom Sharing 2 walls 3x1		207,00	
<input type="checkbox"/> Ref.: ALMC2M04 MC-10 Storeroom Sharing 2 walls 2x2		207,00	
<input type="checkbox"/> Ref.: ALMC2M05 MC-10 Storeroom Sharing 2 walls 3x2		255,00	
<input type="checkbox"/> Ref.: ALOC1M01 OCT Storeroom Sharing 1 wall 1x1		137,00	
<input type="checkbox"/> Ref.: ALOC1M02 OCT Storeroom Sharing 1 wall 2x1		174,00	
<input type="checkbox"/> Ref.: ALOC1M03 OCT Storeroom Sharing 1 wall 3x1		211,00	
<input type="checkbox"/> Ref.: ALOC1M04 OCT Storeroom Sharing 1 wall 2x2		248,00	
<input type="checkbox"/> Ref.: ALOC1M05 OCT Storeroom Sharing 1 wall 3x2		285,00	
<input type="checkbox"/> Ref.: ALOC2M01 OCT Storeroom Sharing 2 walls 1x1		99,00	
<input type="checkbox"/> Ref.: ALOC2M02 OCT Storeroom Sharing 2 walls 2x1		137,00	
<input type="checkbox"/> Ref.: ALOC2M03 OCT Storeroom Sharing 2 walls 3x1		174,00	
<input type="checkbox"/> Ref.: ALOC2M04 OCT Storeroom Sharing 2 walls 2x2		174,00	
<input type="checkbox"/> Ref.: ALOC2M05 OCT Storeroom Sharing 2 walls 3x2		211,00	

DEADLINE FOR SENDING THIS FORM: 4 WORKING DAYS BEFORE SET-UP. ANY APPLICATION RECEIVED WITH LESS THAN 4 WORKING DAYS BEFORE THE START OF SET UP, WILL IMPLY A 25% SURCHARGE ON THE TOTAL RATE. AVAILABILITY OF ALL REFERENCES IS NOT GUARANTEED. PLEASE SEND THIS FORM BY EMAIL: servicecenter@feriavalencia.com

Date, signature, and company stamp

Date: Valencia, / / 202....

Furniture and Complementary Accessories Rental **12F**

APPLICATION FORM

2022

TRADE FAIR:

Exhibiting Firm:

Contact:

Stand Number:

E-mail:

ACCESSORIES RENTAL

RATES (VAT not included)

DESCRIPTION	QUANTITY	EUROS / UNIT	TOTAL EUROS
<input type="checkbox"/> Ref.: 2ESTANTE Horizontal Shelf Modular System		21,00	
<input type="checkbox"/> Ref.: 1ESTANTE Inclined Shelf Modular System		21,00	
<input type="checkbox"/> Ref.: ESTA001 Horizontal Shelf Agglomerated		38,00	
<input type="checkbox"/> Ref.: ESTA004 Horizontal Shelf Melamime		40,00	
<input type="checkbox"/> Ref.: ESTA005 Inclined Shelf Melamine		40,00	
<input type="checkbox"/> Ref.: PASEP300 Wall OCT Systeml		39,00	
<input type="checkbox"/> Ref.: 2PUERTAS Door OCT System		71,00	
<input type="checkbox"/> Ref.: PSCMC300 Wall MC 10		50,00	
<input type="checkbox"/> Ref.: PSCMC200 Wall MC 10		53,00	
<input type="checkbox"/> Ref.: 7PUERTAS Wall MC 10		64,00	
<input type="checkbox"/> Ref.: 4VITRINA Showcase with glass and light		202,00	
<input type="checkbox"/> Ref.: 7VITRINA Showcase with glass and light		170,00	
<input type="checkbox"/> Ref.: 5VITRINA Showcase with glass and light		148,00	

The plan MUST be sent. If it is not received, the location of the services will be up to FERIA VALENCIA, with no possibility of further changes during the assembly of the stand.

DEADLINE FOR SENDING THIS FORM: 4 WORKING DAYS BEFORE SET-UP. ANY APPLICATION RECEIVED WITH LESS THAN 4 WORKING DAYS BEFORE THE START OF SET UP, WILL IMPLY A 25% SURCHARGE ON THE TOTAL RATE. AVAILABILITY OF ALL REFERENCES IS NOT GUARANTEED. PLEASE SEND THIS FORM BY EMAIL: servicecenter@feriavalencia.com

Date, signature, and company stamp

Date: Valencia, / / 202....



FERIA VALENCIA

2022

TRADE FAIR:	
Exhibiting Firm:	
Contact:	Stand Number:
E-mail:	

Standard broadband service: Internet Connection Service speeds: 10 MB. This connection enables standard internet services like browsing, e-mail, etc. Connection is via Wi-Fi network, per individual computer and is no externally addressable.
If you are using virtual private network (VPN) we recommend to use the cable connection.

IT IS NOT PERMITTED: Allowed to use private WIFI network if you need this service, please contact with sistemas@feriavalencia.com

RATES (VAT not included)

1.	WIFI INTERNET CONNECTION	10 MB	Nº
	1 line for whole event	100 €	
	5 lines for whole event	400 €	

2.	CABLE INTERNET CONNECTION	10 MB	Nº
	Cable connection:	300 € / event.	
	Cable connection+Public IP:	550 € / event.	

3.	LOCAL AREA NETWORK (LAN)		Nº
	* Switch (8 ports):	75 € / event.	
	* Maximun connection 7 computers Installation network cabling (max 25 m/l): 40€/computer		

4. **Other special services:**
Please contact with: sistemas@feriavalencia.com

DEADLINE FOR SENDING THIS FORM: 1 MONTH BEFORE SET-UP.
PLEASE SEND THIS FORM BY E-MAIL: servicecenter@feriavalencia.com

Date, signature, and company stamp

REQUIREMENTS:

1. The customer's computer should have a TCP/IP protocol configuration and use DHCP for automatic TCP/IP configuration and avail of a browser (Internet Explorer, Mozilla...).
2. The customer will have to avail of one or various sockets to meet its electrical requirements for each computer. Power supply is not included.
3. Since that the number of Internet connections is limited, this service should be applied for at least one month in advance. Verify availability of lines.

TECHNICAL SPECIFICATIONS:

1. This is an Internet Connection Service. The connection with the customer's computer is made generally via WI-FI, although FERIA VALENCIA reserves the right to supply the connection using a copper wire with RJ45 connector if the service characteristics so require.
2. The customer's computer should have a TCP/IP protocol configuration and use DHCP for automatic TCP/IP configuration. This service is provided only for one computer per contracted service.
3. The initial connection will be made by the customer itself with the assistance of the instructions provided by Service Center
4. This connection includes no Antivirus, Firewall or Intrusion Detection Service. It is the customer's own responsibility to provide the necessary security systems, including antivirus and anti-intrusion. The customer commits itself to refrain from entering the FERIA VALENCIA internet systems or of other customers connected to the systems. Despite the security measures implemented by FERIA VALENCIA, and those taken by the customer, there still exists the possibility of some type of security incident, in which case FERIA VALENCIA does not accept responsibility for any possible consequences.
5. FERIA VALENCIA reserves the right to disconnect from the network any computer that may cause or is causing problems to the network as a whole.
6. If you wish to order additional services, please consult our System Department for specifications. sistemas@feriavalencia.com

CONNECTION:

- The details to configure the WIFI connection must be collected at the Service Center Office.
- For cable connection the instructions and ROUTER must be collected at the Service Center Office.

2022

TRADE FAIR:	
Exhibiting Firm:	
Contact:	Stand Number:
E-mail:	

 Requests CarpetingRequested area (sqm) Colour/s

You do not need to contract the carpet service if you have booked a shell scheme.

IF THE FLOOR IS NOT GOING TO BE ALL THE SAME COLOUR, A DRAWING MUST BE ATTACHED

RATES (VAT not included)

- Single-colour carpet: 6 €/sqm
- Colour combination: 7 €/sqm

LIST OF AVAILABLE COLOURS

- | | | | |
|------------|---------------|-------------------|------------------|
| · Sahara | · Jasper Sand | · Anthracite Grey | · Turquoise Blue |
| · Mink | · Light Green | · Black | · Mid Brown |
| · Gold | · Leaf Green | · White | · Dark Brown |
| · Whisky | · Grass Green | · Air force Blue | · Jasper Brown |
| · Yellow | · Dark Green | · Lavender Blue | · Violet |
| · Sienna | · Pearl Grey | · Duchess Blue | · Fuchsia |
| · Red | · Jasper Grey | · Navy Blue | · Pink |
| · Burgundy | · Dark Grey | · Deep Blue | · Bubblegum Pink |

OTHER SERVICES AVAILABLE - REQUEST A CUSTOMISED QUOTE

- | | |
|--------------------------------------|------------------|
| · Lawn-type carpet (Synthetic fibre) | · KNOTTED carpet |
| · Jute carpet (Natural fibre) | · TUFTED carpet |
| · Bamboo carpet (Natural fibre) | |

DEADLINE FOR SENDING THIS FORM: 4 WORKING DAYS BEFORE SET-UP. ANY APPLICATION RECEIVED WITH LESS THAN 4 WORKING DAYS BEFORE THE START OF SET UP, WILL IMPLY A 25% SURCHARGE ON THE TOTAL RATE. AVAILABILITY OF ALL REFERENCES IS NOT GUARANTEED. PLEASE SEND THIS FORM BY EMAIL: servicecenter@feriavalencia.com

Date, signature, and company stamp

2022

TRADE FAIR:

Exhibiting Firm:

Contact:

Stand Number:

E-mail:

Requests Wooden Platform

- | | |
|---|---|
| <input type="checkbox"/> 1. Chipboard (3 cm high) | <input type="checkbox"/> 5. White melamine (3,5 cm high) |
| <input type="checkbox"/> 2. Chipboard with ramp (11 cm high) | <input type="checkbox"/> 6. White melamine (5,1 cm high) |
| <input type="checkbox"/> 3. Double Chipboard (4,8 cm high) | <input type="checkbox"/> 7. White melamine with ramp (10 cm high) |
| <input type="checkbox"/> 4. Double Chipboard with ramp (11 cm high) | |

Requested Area (sqm)

- IF THE PLATFORM DOES NOT COVER THE ENTIRE FLOOR AREA OF THE STAND AN ANNOTATED DRAWING MUST BE ATTACHED.
- **MINIMUM CONTRACT 16 sqm**

RATES (VAT not included)

- | | |
|--|---|
| · Chipboard (3 cm high): 8€ /sqm | · White melamine (3,5 cm high): 22,5€ /sqm |
| · Chipboard with ramp (11 cm high): 16€ /sqm | · White melamine (5,1 cm high): 25€ /sqm |
| · Double Chipboard (4,8 cm high): 15€ /sqm | · White melamine with ramp (10 cm high): 26€ /sqm |
| · Double Chipboard with ramp (11 cm high): 19,50€ /sqm | |

DEADLINE FOR SENDING THIS FORM: 4 WORKING DAYS BEFORE SET-UP. ANY APPLICATION RECEIVED WITH LESS THAN 4 WORKING DAYS BEFORE THE START OF SET UP, WILL IMPLY A 25% SURCHARGE ON THE TOTAL RATE. AVAILABILITY OF ALL REFERENCES IS NOT GUARANTEED. PLEASE SEND THIS FORM BY EMAIL: servicecenter@feriavalencia.com

Date, signature, and company stamp

Date: Valencia, / / 202....

APPLICATION FORM

2022

TRADE FAIR:	
Exhibiting Firm:	
Contact:	Stand Number:
E-mail:	

To hire meeting rooms of the Exhibition Centre just tick the box above and a member of FERIA VALENCIA will contact your company. Rates indicated down here will apply 20% discount available for exhibitors on rates for hiring rooms during trade fairs.

RATES (VAT not included)

MEETING ROOMS	SIZE (m ²)	CAPACITY (seats)	RATES €/1 HOUR	RATES €/HALF DAY	RATES €/1 DAY
Alicante	70	20	135	365	620
Castellón	70	56	135	365	620
Valencia	105	45	135	365	620
Assembly Hall	500	300	345	1.120	2.110
Buyer's Club	15+17+15	12+8+8	58	175	280
Buyer's Club - (Consular Room)	56	45	120	365	565
Joaquín Rodrigo (4 Rooms)*	40	30*4	115	365	565
Joaquín Rodrigo - Big Room	135	130	225	845	1.370
Ausias March (3 Rooms)*	40	30*3	115	365	565
Ausias March (Big Rooms)	132	110	225	845	1.370
VIP Room Mall	852	140	165	640	1.065
Board Room	1.125	118	240	855	1.595
VIP Room Hall 8	330	54	165	640	1.065

* Prices per room

FERIA VALENCIA also has its own Events Centre, a building designed especially to hold conferences, congresses, seminars or other events related with trade fairs. It is equipped with the best and latest services and is also available with an optional contiguous exhibition hall with 10.000m² allowing for the perfection combination of a congress and an exhibition.

More information on the Events Centre at: <http://centroeventos.feriavalencia.com>

DEADLINE FOR SENDING THIS FORM: 4 WORKING DAYS BEFORE SET-UP. ANY APPLICATION RECEIVED WITH LESS THAN 4 WORKING DAYS BEFORE THE START OF SET UP, WILL IMPLY A 25% SURCHARGE ON THE TOTAL RATE. AVAILABILITY OF ALL REFERENCES IS NOT GUARANTEED. PLEASE SEND THIS FORM BY EMAIL: servicecenter@feriavalencia.com

Date, signature, and company stamp

ROOM EQUIPMENT AND FEATURES:

2022

	Video projector	Loudspeaker	Voice and data	Control Cabin	DVD Player	Video-camera	LCD Screen	Simultaneous interpretation
Alicante	<input checked="" type="checkbox"/>	<input type="checkbox"/>	<input checked="" type="checkbox"/>	<input type="checkbox"/>	<input type="checkbox"/>	<input type="checkbox"/>	<input type="checkbox"/>	<input type="checkbox"/>
Castellón	2	<input checked="" type="checkbox"/>	<input checked="" type="checkbox"/>	<input type="checkbox"/>	<input type="checkbox"/>	<input type="checkbox"/>	<input type="checkbox"/>	<input type="checkbox"/>
Valencia	2	<input checked="" type="checkbox"/>	<input checked="" type="checkbox"/>	<input type="checkbox"/>	<input type="checkbox"/>	<input type="checkbox"/>	<input type="checkbox"/>	<input type="checkbox"/>
Assembly Hall	<input checked="" type="checkbox"/>	<input checked="" type="checkbox"/>	<input checked="" type="checkbox"/>	<input type="checkbox"/>	<input type="checkbox"/>	1	<input checked="" type="checkbox"/>	<input checked="" type="checkbox"/>
Buyer's Club (3 Rooms)	<input checked="" type="checkbox"/>	<input type="checkbox"/>	<input checked="" type="checkbox"/>	<input type="checkbox"/>	<input type="checkbox"/>	<input type="checkbox"/>	<input type="checkbox"/>	<input type="checkbox"/>
Buyer's Club Consular Room	<input checked="" type="checkbox"/>	<input checked="" type="checkbox"/>	<input checked="" type="checkbox"/>	<input type="checkbox"/>	<input type="checkbox"/>	<input type="checkbox"/>	<input type="checkbox"/>	<input type="checkbox"/>
Joaquín Rodrigo (4 Rooms)	<input checked="" type="checkbox"/>	<input checked="" type="checkbox"/>	<input checked="" type="checkbox"/>	<input type="checkbox"/>	<input type="checkbox"/>	<input type="checkbox"/>	<input type="checkbox"/>	<input type="checkbox"/>
Joaquín Rodrigo Big Room	2	<input checked="" type="checkbox"/>	<input checked="" type="checkbox"/>	<input type="checkbox"/>	<input type="checkbox"/>	<input type="checkbox"/>	<input type="checkbox"/>	<input type="checkbox"/>
Ausias March (3 Rooms)	<input checked="" type="checkbox"/>	<input checked="" type="checkbox"/>	<input checked="" type="checkbox"/>	<input type="checkbox"/>	<input type="checkbox"/>	<input type="checkbox"/>	<input type="checkbox"/>	<input type="checkbox"/>
Ausias March Big Room	2	<input checked="" type="checkbox"/>	<input checked="" type="checkbox"/>	<input type="checkbox"/>	<input type="checkbox"/>	<input type="checkbox"/>	<input type="checkbox"/>	<input type="checkbox"/>
VIP Room Mall	<input type="checkbox"/>	<input type="checkbox"/>	<input type="checkbox"/>	<input type="checkbox"/>	<input type="checkbox"/>	<input type="checkbox"/>	<input type="checkbox"/>	<input type="checkbox"/>
Board Room	<input checked="" type="checkbox"/>	<input type="checkbox"/>	<input type="checkbox"/>	<input type="checkbox"/>	<input type="checkbox"/>	<input type="checkbox"/>	<input type="checkbox"/>	<input type="checkbox"/>
VIP Room Hall 8	<input type="checkbox"/>	<input type="checkbox"/>	<input type="checkbox"/>	<input type="checkbox"/>	<input type="checkbox"/>	<input type="checkbox"/>	<input type="checkbox"/>	<input type="checkbox"/>

Events Centre	Video projector	Loudspeaker	Voice and data	Control Cabin	DVD Player	Video-camera	LCD Screen	Simultaneous interpretation
Meeting Room 4A	<input checked="" type="checkbox"/>	<input checked="" type="checkbox"/>	<input checked="" type="checkbox"/>	<input checked="" type="checkbox"/>	<input checked="" type="checkbox"/>	<input type="checkbox"/>	<input checked="" type="checkbox"/>	<input checked="" type="checkbox"/>
Meeting Room 4C	<input checked="" type="checkbox"/>	<input checked="" type="checkbox"/>	<input checked="" type="checkbox"/>	<input checked="" type="checkbox"/>	<input checked="" type="checkbox"/>	<input type="checkbox"/>	<input checked="" type="checkbox"/>	<input checked="" type="checkbox"/>
Meeting Room 4F	<input checked="" type="checkbox"/>	<input checked="" type="checkbox"/>	<input checked="" type="checkbox"/>	<input checked="" type="checkbox"/>	<input checked="" type="checkbox"/>	<input type="checkbox"/>	<input checked="" type="checkbox"/>	<input checked="" type="checkbox"/>
Meeting Room 4D	<input checked="" type="checkbox"/>	<input checked="" type="checkbox"/>	<input checked="" type="checkbox"/>	<input checked="" type="checkbox"/>	<input checked="" type="checkbox"/>	<input type="checkbox"/>	<input checked="" type="checkbox"/>	<input checked="" type="checkbox"/>
Auditorium 3A	2	<input checked="" type="checkbox"/>	<input checked="" type="checkbox"/>	<input checked="" type="checkbox"/>	<input checked="" type="checkbox"/>	2	<input checked="" type="checkbox"/>	<input checked="" type="checkbox"/>
Meeting Room 3F	<input checked="" type="checkbox"/>	<input checked="" type="checkbox"/>	<input checked="" type="checkbox"/>	<input checked="" type="checkbox"/>	<input checked="" type="checkbox"/>	<input type="checkbox"/>	<input checked="" type="checkbox"/>	<input checked="" type="checkbox"/>
Meeting Room 3G	<input checked="" type="checkbox"/>	<input checked="" type="checkbox"/>	<input checked="" type="checkbox"/>	<input checked="" type="checkbox"/>	<input checked="" type="checkbox"/>	<input type="checkbox"/>	<input checked="" type="checkbox"/>	<input checked="" type="checkbox"/>
Meeting Rooms, 3B, 3C, 3D	<input checked="" type="checkbox"/>	<input checked="" type="checkbox"/>	<input checked="" type="checkbox"/>	<input type="checkbox"/>	<input checked="" type="checkbox"/>	<input type="checkbox"/>	<input type="checkbox"/>	<input type="checkbox"/>
Meeting Room, 3E, 3H	<input type="checkbox"/>	<input checked="" type="checkbox"/>	<input checked="" type="checkbox"/>	<input type="checkbox"/>	<input type="checkbox"/>	<input type="checkbox"/>	<input type="checkbox"/>	<input type="checkbox"/>
Meeting Room 2D	<input type="checkbox"/>	<input checked="" type="checkbox"/>	<input checked="" type="checkbox"/>	<input type="checkbox"/>	<input type="checkbox"/>	<input type="checkbox"/>	<input type="checkbox"/>	<input type="checkbox"/>
Meeting Room 2E	<input checked="" type="checkbox"/>	<input checked="" type="checkbox"/>	<input checked="" type="checkbox"/>	<input type="checkbox"/>	<input checked="" type="checkbox"/>	<input type="checkbox"/>	<input checked="" type="checkbox"/>	<input type="checkbox"/>
Meeting Room 2F	<input checked="" type="checkbox"/>	<input checked="" type="checkbox"/>	<input checked="" type="checkbox"/>	<input type="checkbox"/>	<input checked="" type="checkbox"/>	<input type="checkbox"/>	<input checked="" type="checkbox"/>	<input type="checkbox"/>
Meeting Room 2G	<input checked="" type="checkbox"/>	<input checked="" type="checkbox"/>	<input checked="" type="checkbox"/>	<input type="checkbox"/>	<input checked="" type="checkbox"/>	<input type="checkbox"/>	<input checked="" type="checkbox"/>	<input type="checkbox"/>
Meeting Room 2H	<input checked="" type="checkbox"/>	<input checked="" type="checkbox"/>	<input checked="" type="checkbox"/>	<input type="checkbox"/>	<input checked="" type="checkbox"/>	<input type="checkbox"/>	<input checked="" type="checkbox"/>	<input type="checkbox"/>
Meeting Room 2I	<input checked="" type="checkbox"/>	<input type="checkbox"/>	<input checked="" type="checkbox"/>	<input type="checkbox"/>	<input checked="" type="checkbox"/>	<input type="checkbox"/>	<input checked="" type="checkbox"/>	<input type="checkbox"/>
Auditorium 1A	3	<input checked="" type="checkbox"/>	<input checked="" type="checkbox"/>	<input checked="" type="checkbox"/>	<input checked="" type="checkbox"/>	3	<input checked="" type="checkbox"/>	<input checked="" type="checkbox"/>

This meeting room does not have this equipment. Requests budget

This meeting room have this equipment

This meeting room have pre-installation for this equipment

2022

TRADE FAIR:	
Exhibiting Firm:	
Contact:	Stand Number:
E-mail:	

Number of Spaces Number of Days

FERIA VALENCIA offers you the possibility of parking during the setting-up and dismantling periods, and during the exhibition days.

Truck's parking, please ask for availability and rates.

Parking P-1 and P-2 auto maximum height 2'10 metres.

Reservations will be accepted upon payment in the Treasury office of **FERIA VALENCIA**. Service subject to availability.

RATES (VAT not included)

- During the event days: 13,89 €/day.
- During assembly and dismantling days please ask for availability and rates.

**DEADLINE FOR SENDING THIS FORM: 4 WORKING DAYS BEFORE SET-UP.
PLEASE SEND THIS FORM BY E-MAIL: servicecenter@feriavalencia.com**

Date, signature, and company stamp

Date: Valencia, / / 202....

2022

TRADE FAIR:

Exhibiting Firm:

Contact:

Stand Number:

E-mail:

The water and drainage service is supplied exclusively through Feria Valencia from the main network located in the floor of the exhibition pavilions. Each water supply/drainage connection consists of a ½ inch section and drainage of 25mm diameter.

Both the main supply as well as the connections with the exhibitor should be accessible at all times; that is to say, they can not be covered by any fixed element, such as platforms or pavements. If these elements are being used, readily accessible registration covers must be available which require no special tools.

The water supply pressure in the exhibition pavilions are:

PAVILIONS	PRESURE
Level 1, Pavilions 1, 2, 3, 4	2Kg/cm. ²
Level 1, Pavilion 5	4Kg/cm. ²
Level 2, Pavilions 1, 2, 3, 4, 6, 7, 8	4Kg/cm. ²
Level 3, Pavilions 1, 2, 3, 4, 6, 7	3Kg/cm. ²
Pavilion 6 bis	No service

WATER/ DRAINAGE Number of connections: Basin Number: Filling of basins and pools Cubic Meters: **RATES (VAT not included)**

- Connection and consumption cost: 210 €
- Rental fee for the sink: 50 € (unit/event)
- Cost of filling (up to one cubic metre): 30 € - 2 € per additional cubic metre

DEADLINE FOR SENDING THIS FORM: 1 MONTH BEFORE SET-UP. ANY APPLICATION RECEIVED WITH LESS THAN 4 WORKING DAYS BEFORE THE START OF SET UP, WILL IMPLY A 25% SURCHARGE ON THE TOTAL RATE. AVAILABILITY OF ALL REFERENCES IS NOT GUARANTEED. PLEASE SEND THIS FORM BY EMAIL: servicecenter@feriavalencia.com

Date, signature, and company stamp

2022

TRADE FAIR:

Exhibiting Firm:

Contact:

Stand Number:

E-mail:

DRAW THE PLAN OF LOCATION OF WATER CONNECTION

The plan **MUST** be sent. If it is not received, the location of the services will be up to FERIA VALENCIA, with no possibility of further changes during the assembly of the stand.

DEADLINE FOR SENDING THIS FORM: 1 MONTH BEFORE SET-UP.
PLEASE SEND THIS FORM BY EMAIL: servicecenter@feriavalencia.com

2022TRADE FAIR: Exhibiting Firm: Contact: Stand Number: E-mail:

The compressed air service is available in exhibition pavilions 1 to 5 on all levels. Feria Valencia will supply the connection at the location, using pressure hoses with 13 mm. inner diameter and 19 mm. external diameter, sufficient for a supply of up to 1.500 litres / minute, with a ½ inch valve with screw thread. The connection to the supply and with machines is the responsibility and task of the exhibitor.

The exhibitor must indicate the volume it expects to consume in litres/minute, applying the coefficient of simultaneity it considers suitable.

The supply points and the connection points used by the exhibitor must be readily accessible at all times; that is to say, they can not be covered with any fixed element, such as column coverings, platforms or pavement. If these elements are being used, readily accessible registration covers must be available, which do not need special tools.

A minimum pressure of 8 bars is guaranteed at any point in the installation. The pressure should be regulated by the exhibitor in function of its needs and using its own means.

COMPRESSED AIR Connection Points: Total Estimated consumption: litres/minute**RATES (VAT not included)**

· Connection cost: 340 €

DEADLINE FOR SENDING THIS FORM: 1 MONTH BEFORE SET-UP. ANY APPLICATION RECEIVED WITH LESS THAN 4 WORKING DAYS BEFORE THE START OF SET UP, WILL IMPLY A 25% SURCHARGE ON THE TOTAL RATE. AVAILABILITY OF ALL REFERENCES IS NOT GUARANTEED. PLEASE SEND THIS FORM BY EMAIL: servicecenter@feriavalencia.com

Date, signature, and company stamp

2022

TRADE FAIR:

Exhibiting Firm:

Contact:

Stand Number:

E-mail:

This service is subcontracted by **FERIA VALENCIA**. For technical details, please contact **MOLDTRANS**.

Tel.: +34 961 134 404 - E-mail: jose.galvez@moldtrans.es / ferias@moldtrans.es

Payment requested concepts must be paid at the offices of the company **MOLDTRANS** located in the Mall Level of the exhibition site.

RATES (VAT not included)

FORKLIFT	Tm.	(€/HOUR)	UNITS	COORD. RATE	SURCHARGE	TOTAL	SERVICE DATE
Minimum Service.(1/2hr)	2´5 Tm	28,30 €		40 € / Stand /u			
1 h.	2´5 Tm	54,55 €		40 € / Stand /u			
* Over forklift 3TM are only allowed in Halls: 5, 6 and 7 ground floor. Request budget							
MANUAL FOKLIFT							
Minimum Service 1 hour	2 Tm	28,30 €		30 € / Stand /u			
LOADING AND UNLOADING STAFF							
Minimum Service 2 hours		35,99 €		40 € / Stand / u			
SELF-LOADERS UP TO							
Minimum Service 3 hours	9 Tm	66,12 €		40 € / Stand / u			
Minimum Service 3 hours	15 Tm	75,32 €		40 € / Stand / u			
Minimum Service 3 hours	20 Tm	100,12 €		40 € / Stand /u			
CRANES UP TO							
Minimum Service 3 hours	30 Tm	84,49 €		40 € / Stand / u			
Minimum Service 3 hours	40 Tm	100,10 €		40 € / Stand / u			
* Cranes over 30Tm permitted only allowed in Halls: 5, 6 and 7 ground floor.							
STORAGE ROOM - STAND DELIVERY(2m³ minimum)(€/ m3)							
Up to 3 m ³		36,48 €		30 € / Stand / u			
Up to 10 m ³		31,72 €		30 € / Stand / u			
Up to 10 m ³		25,03 €		30 € / Stand /u			
STORAGE OF PACKAGING AND EMPTIES(2m³ minimum)(€/ m3)							
Up to 3 m ³		29,08 €		40 € / Stand / u			
Up to 10 m ³		26,16 €		40 € / Stand / u			
More than 10 m ³		24,12 €		40 € / Stand / u			
STAND - STORE ROOM DELIVERY(2m³ minimum) (€/ m3)							
Up to 3 m ³		36,48 €		35 € / Stand / u			
Up to 10 m ³		31,72 €		35 € / Stand / u			
More than 10 m ³		25,03 €		35 € / Stand / u			
FORKLIFT (self-drive)	WORKING HEIGHT	(€/day)	INSURANCE	WASTE MANAGEMENT	TRANSPORT	UNITS	TOTAL
	2´5 Tm	105,78 €	9,5 €/day	12,00 €	125,00 €		

Continued in the next page

Date, signature, and company stamp

2022

TRADE FAIR:

Exhibiting Firm:

Contact:

Stand Number:

E-mail:

ELECTRIC SCISSOR LIFT (WITHOUT DRIVER) (€/DAY)	INSURANCE	WASTE RATE	TRANSPORT	UNITS	TOTAL
--	-----------	------------	-----------	-------	-------

8,00 mts	85€/day	8'5€/day	12€	125€/u	

DIESEL ARTICULATED PLATTFORM (WITHOUT DRIVER) (€/DAY)	INSURANCE	WASTE RATE	TRANSPORT	UNITS	TOTAL
---	-----------	------------	-----------	-------	-------

12 mts	119'00€/día	11'90€/seg.día	12 €	125'00€/u	
16 mts	138'00€/día	13'80€/seg.día	12 €	125'00€/u	
26 mts	206'70€/día	20'67€/seg.día	12 €	265'00€/u	

RENTAL TERMS:

1. All services are paid in Moldtrans office located in the MALL Level at Exhibition site or by Transfer.
2. Only in the lift up to 2'5 tm there a minimum service of 1 / 2 hr on a normal schedule
3. All our services are requested via fax or mail with 48 hours in advance.
4. The request shall indicate: location, start time, end time and type of merchandise.
5. The service truck, crane and staff will have a 100% increase on weekends and holidays.
6. The customer's signature on the slip will mean acceptance.
7. Hours: from 8,00 to 20,00h Monday to Friday. Outside normal working will have a 75% Increase
8. Waste Management: 12€ per contract.
9. Gas-oil consumption paid directly by the customer.

Date, signature, and company stamp

APPLICATION FORM

2022

TRADE FAIR:	
Exhibiting Firm:	
Contact:	Stand Number:
E-mail:	

The Feria Valencia Press Office prepares different types of news documents for release to the media. In addition to all the information on events and associated activities, we provide journalists with descriptions and pictures of exhibitors' new developments.

This service costs exhibitors nothing extra, and it's a great promotional opportunity.

If you'd like information on your company to be included in our press packets, just fill out the form.

**For more information:
Press Office**

prensa@feriavalencia.com

Tel.: +34 963 861 303 - +34 963 861 116

RATES

· FREE SERVICE

PLEASE SEND THIS FORM BY EMAIL: servicecenter@feriavalencia.com

Date, signature, and company stamp

Date: Valencia, / / 202....

2022

TRADE FAIR:

Exhibiting Firm:

Contact:

Stand Number:

E-mail:

- Number of phones
- ISDN Line

RATES (VAT not included)

- Deposit: 100 €
- Installation fee: 70 €
- ISDN surcharge: 150 €
- Service fee: 0,10 € / *per unit as indicated by meter*

The installation fee and the deposit must be paid when ordering the service.

The service fee must be paid upon return of the device.

The telephone connection and the ISDN surcharge do not include computer interconnection, nor Internet Server. The two lines come with a standard RJ - 11 jack (for telephone) and RJ - 45 for ISDN modem router.

DEADLINE FOR SENDING THIS FORM: 4 WORKING DAYS BEFORE SET-UP. ANY APPLICATION RECEIVED WITH LESS THAN 4 WORKING DAYS BEFORE THE START OF SET UP, WILL IMPLY A 25% SURCHARGE ON THE TOTAL RATE. AVAILABILITY OF ALL REFERENCES IS NOT GUARANTEED. PLEASE SEND THIS FORM BY EMAIL: servicecenter@feriavalencia.com

Date, signature, and company stamp

Date: Valencia, / / 202....

2022

TRADE FAIR:	
Exhibiting Firm:	
Contact:	Stand Number:
E-mail:	

Before beginning the assembly or construction of its stand, the exhibitor, or other company working on its behalf, must present detailed plans for prior approval. The stand must fulfil the regulations included in the Application for Participation form (see Conditions), as well as the Rules and Regulations for Setting-up and dismantling.

In this present form, all work to be undertaken must be clearly specified, and must comply with the sketch of the stand (obligatory requirement), which must also be presented to the organization of the trade fair for approval by the Technical Department at FERIA VALENCIA.

In addition, to use cover of general services and extensions of opening and closing times, decorators will be obliged to pay the detailed rates in the reverse, upon application for assembly passes.

DATA OF THE DECORATOR:

Name:

Address:

City:

Phone: Fax:

E-mail:

Description of the products to be used for construction and to be exhibited. THIS FORM MUST BE RETURNED WITH THE BUILD-UP PROJECT DRAWINGS ATTACHED:

.....

.....

.....

.....

.....

If you additional information (height, weight, measurement,etc.) contact with Assembly Department:
Tel.: +34 902 747 338 - E.mail: montajesyservicios@feriavalencia.com

DEADLINE FOR SENDING THIS FORM: 4 WORKING DAYS BEFORE SET-UP. ANY APPLICATION RECEIVED WITH LESS THAN 4 WORKING DAYS BEFORE THE START OF SET UP, WILL IMPLY A 25% SURCHARGE ON THE TOTAL RATE. AVAILABILITY OF ALL REFERENCES IS NOT GUARANTEED. PLEASE SEND THIS FORM BY EMAIL: servicecenter@feriavalencia.com

Date, signature, and company stamp

RATES (VAT not included)

1. Service charge for assembly work on agreed dates	4 €/m ²
2. Service charge for assembly work before agreed date	8 €/m ²
3. Service charge for assembly work on weekends and holidays	5 €/m ² /day
4. Exhibitor charge for night-time assembly work	150 €/stand/h.
5. Exhibitor charge for assembly work before agreed date	5 €/m ² /day
6. Exhibitor charge for assembly work on weekends and holidays	5 €/m ² /day
7. Fees for joinery work on agreed dates	5 €/m ²
8. Fees for joinery work before agreed date	5 €/m ² /day
9. Fees for joinery work on weekends and holidays	5 €/m ² /day
10. Fees for laying carpet / flooring	1.55 €/m ²
11. Fees for ceiling fixture points	22 €/point of lineal metre
12. Fees for assembly work for examination of ceiling fixture points	
12a. From 1 to 10 points.	30,80 €/point
12b. From 11 to 30 points.	28,60 €/point
12c. From 31 to 50 points.	25,30 €/point
12d. More than 51 points	20,90 €/point
13. Deposit for ceiling fixture points on Levels 1 & 2	55 €/point of lineal metre
14. Deposit for ceiling fixture points on Level 3 & Pavilion 5	110 €/point of lineal metre
15. Fees for welding service	74 €/hour
16. Fees for disconnection of lights by Feria Valencia services	40 €/light
17. Deposit for disconnection of lights by outsourced service company	40 €/light
18. Fees for fitter of modular mezzanine on stipulated date	4 €/m ²
19. Fees for fitter of modular mezzanine before stipulated date	5 €/m ² /day
20. Fees for fitter of joinery mezzanine on stipulated date	5 €/m ²
21. Fees for fitter of joinery mezzanine before stipulated date	5 €/m ² /day
22. Fees for access machinery (Forklift and Platform)	
-Machinery Day	20€/day
-Machinery Night	15€ /night

2022

TRADE FAIR:

Exhibiting Firm:

Contact:

Stand Number:

E-mail:

CATEGORY	HOTEL	DISTANCE TO FERIA VALENCIA
5*****	WESTIN	9,2 Km.
4****	EUROSTARS	4,7 Km.
4****	AC VALENCIA	8,6 Km.
4****	AQUA	8,7 Km.
4****	BARCELO	7,9 Km.
4****	BEATRIZ REY D.JAIME	7,4 Km.
4****	HOLIDAY INN	7,4 Km.
4****	NH CENTER	4,4 Km.
4****	NH LAS ARTES	7,9 Km.
4****	NOVOTEL	4,7 Km.
4****	SILKEN	7,2 Km.
4****	SOROLLA PALACE	2,2 Km.
4****	TRYP OCEANIC	11,4 Km.
4****	VALENCIA CENTER	9,3 Km.
4****	VINCCI LYS	8,6 Km.
4****	VINCCI PALACE	8,6 Km.
3***	BELERET	0,5 Km.
3***	VORA FIRA	0,2 Km.
2**	IBIS	4,7 Km.

· See reverse side for service terms

2022

TERMS

- The rates indicated on the form will be applied as long as booking are made through official office. To book rooms, contact them directly:



Contact Person: Amparo
Mail: feriavalencia@viajeseci.es
Tel.: 34 96 386 15 44 / +34 96 386 1358
Fax: +34 96 386 1359
Hours: 9:00 a 14:00 y 16:00 a 19:00
24-hour telephone: + 34 96 386 15 44

- The HOTEL rates include breakfast. They do not include VAT.
- Rates are valid throughout the year for exhibitors at FERIA VALENCIA. Subject to availability.

APPLICATION FORM

2022

TRADE FAIR:	
Exhibiting Firm:	
Contact:	Stand Number:
E-mail:	

- 1. "Full pre-show" Cleaning Service
- 2. "Maintenance" Cleaning Service (per action)
- 3. "Spot" Cleaning Service

RATES (VAT not included)

DESCRIPTION	QUANTITY		RATES	TOTAL EUROS
1. "Full pre-show" Cleaning Service	sq.m		2,51 €/sq.m	
2. "Maintenance" Cleaning Service (per action)	sq.m	n° of times:	0,85 €/sq.m	
	FROM: <input type="text"/> <input type="text"/> DAY MONTH		TO: <input type="text"/> <input type="text"/> DAY MONTH	
3. "Spot" Cleaning Service maximum service 1 hr.			15,88 €/hour	
	DATE: <input type="text"/> <input type="text"/> DAY MONTH		HOUR: <input type="text"/> <input type="text"/>	
SPOT SERVICES NEEDED: <input style="width: 400px;" type="text"/>				

The three types of service include:

- The "FULL PRE-SHOW" service includes the thorough cleaning of all the components of the stand (including glass surfaces) up to a height of two metres, once the assembly of the stand has been completed, and before the show is officially opened.
- The "MAINTENANCE" cleaning service includes a maintenance cleaning of all the components of the stand (including glass surfaces) up to a height of two metres during the time the show is held. This service may be requested as often as needed. Please indicate the number of times you will need the MAINTENANCE service.
- The SPOT cleaning service includes several specific services: dish washing, cleaning lavatories installed in the stand itself, cleaning carpet or other floor covering, and continuous cleaning.

DEADLINE FOR SENDING THIS FORM: 4 WORKING DAYS BEFORE SET-UP. ANY APPLICATION RECEIVED WITH LESS THAN 4 WORKING DAYS BEFORE THE START OF SET UP, WILL IMPLY A 25% SURCHARGE ON THE TOTAL RATE. AVAILABILITY OF ALL REFERENCES IS NOT GUARANTEED. PLEASE SEND THIS FORM BY EMAIL: servicecenter@feriavalencia.com

Date, signature, and company stamp

APPLICATION FORM

2022

TRADE FAIR:

Exhibiting Firm:

Contact:

Stand Number:

E-mail:

IMPORTANT NOTE: Upon completion of task of dismantling of the installations, must leave the premises in the same condition as you found it.

If you need to hire the waste removal service , Feria Valencia offers this service on an optional basis.

If the exhibitor does not apply for it but rubble appears in his/her locations, FERIA VALENCIA will bill the amount of the withdrawal notice thereof to the exhibitor with a 20% of surcharge.

CONTAINERS OPTIONS
OPTION A : CLEAN WOOD

	Units	PRICE (Without VAT)
7m3	<input type="text"/>	177 €
30m3	<input type="text"/>	531 €
Total	<input type="text"/>	

OPTION B: OTHER RESIDUE /WASTE

	Units	PRICE (Without VAT)
7m3	<input type="text"/>	394 €
30m3	<input type="text"/>	1.150 €
Total	<input type="text"/>	

VAT application will be 10%

If, during the dismantling, you require additional containers with regard to initially requested in this form, we inform you that there will be invoiced in accordance with the real requirement for the removal of the waste generated, to prior notification to the exhibitor.

Date, signature, and company stamp

APPLICATION FORM

2022



Ref.: 4-1
Base 70W
Halogen Lamp



Ref.: 4-2 Ref.: 4-4
Fixed 70 W / 150 W
Halogen Lamp



Ref.: 4-3 (2 Modelos)
Halogen Lamp 150W
Base and Riel



Ref.: L20
FIXED LED LAMP 20W



Ref.: L30
FIXED LED LAMP 30W



Ref.: L50
FIXED LED LAMP 50W



Ref.: LS50
Projector LED LAMP
50W



Ref.: LS100
Projector LED LAMP
100W



Ref.: L300
Projector LED LAMP
300W



Ref.: LA7
FIXED DICHROIC
RING LAMP 7W



Ref.: LC30
FIXED RING LED
LAMP 30W



Ref.: LR30
FIXED RECTANGULAR
LED LAMP 30W



Ref.: ML6
MODULE BACKLIP
LED 6W



Ref.: TL14
STRIP LED 14W (L/M)

2022

TRADE FAIR:

Exhibiting Firm:

Contact:

Stand Number:

E-mail:

HALOGEN LAMPS

RATES (VAT not included)

DESCRIPTION	QUANTITY	EUROS / UNIT	TOTAL EUROS
<input type="checkbox"/> Ref.: 4-1 Base 70w halogen lamp		55,00	
<input type="checkbox"/> Ref.: 4-2 Fixed 70w halogen lamp		50,00	
<input type="checkbox"/> Ref.: 4-3 Halogen lamp 150w/Base and rail		65,00	
<input type="checkbox"/> Ref.: 4-4 Fixed halogen lamp 150w		50,00	

LED LAMP

RATES (VAT not included)

DESCRIPCIÓN	CANTIDAD	EUROS UNIDAD	TOTAL EUROS
<input type="checkbox"/> Ref.: L20 FIXED LED LAMP 20W		24,00 €	
<input type="checkbox"/> Ref.: L30 FIXED LED LAMP 30W		36,00 €	
<input type="checkbox"/> Ref.: L50 FIXED LED LAMP 50W		48,00 €	
<input type="checkbox"/> Ref.: LS50 Projector LED LAMP 50W		48,00 €	
<input type="checkbox"/> Ref.: LS100 Projector LED LAMP 100W		54,00 €	
<input type="checkbox"/> Ref.: L300 Projector LED LAMP 300W		60,00 €	
<input type="checkbox"/> Ref.: LA7 FIXED DICHROIC RING LAMP 7W		24,00 €	
<input type="checkbox"/> Ref.: LC30 FIXED RING LED LAMP 30W		36,00 €	
<input type="checkbox"/> Ref.: LR30 FIXED RECTANGULAR LED LAMP 30W		36,00 €	
<input type="checkbox"/> Ref.: ML6 MODULE BACKLIP LED 6W		6,00 €	
<input type="checkbox"/> Ref.: TL14 STRIP LED 14W (L/M)		18,00 €	

DEADLINE FOR SENDING THIS FORM: 4 WORKING DAYS BEFORE SET-UP. ANY APPLICATION RECEIVED WITH LESS THAN 4 WORKING DAYS BEFORE THE START OF SET UP, WILL IMPLY A 25% SURCHARGE ON THE TOTAL RATE. AVAILABILITY OF ALL REFERENCES IS NOT GUARANTEED. PLEASE SEND THIS FORM BY EMAIL: servicecenter@feriavalencia.com

Date, signature, and company stamp

APPLICATION FORM

2022

TRADE FAIR:

Exhibiting Firm:

Contact:

Stand Number:

E-mail:

SHUCKO SOCKETS AND POWER CONNECTIONS

RATES (VAT not included)

DESCRIPTION	QUANTITY	EUROS / UNIT	TOTAL EUROS
<input type="checkbox"/> Ref.: 8-1 air socket up to 500w		12,00	
<input type="checkbox"/> Ref.: 8-2 Earthed socket up to 500w		16,50	
<input type="checkbox"/> Ref.: 8-3 Multiple socket 2/3/4 units		24,00	
<input type="checkbox"/> Ref.: 8-5 Power connection up to 2kw		17,50	

HIGH VOLTAGE POWER CONNECTIONS

RATES (VAT not included)

DESCRIPTION	QUANTITY	EUROS / UNIT	TOTAL EUROS
<input type="checkbox"/> Ref.: 12-1 Single - phase socket 16A		12,50	
<input type="checkbox"/> Ref.: 12-2 Single - phase socket 32A		19,00	
<input type="checkbox"/> Ref.: 12-3 Three phase / TT Socket 16A		19,00	
<input type="checkbox"/> Ref.: 12-4 Three phase / TT Socket 32A		26,00	
<input type="checkbox"/> Ref.: 12-5 Three phase/N/ TT Socket 16A		18,50	
<input type="checkbox"/> Ref.: 12-6 Three phase /N/TT Socket 32A		26,00	
<input type="checkbox"/> Ref.: 12-7 Three phase /N/TT Socket 63A		37,00	

DEADLINE FOR SENDING THIS FORM: 4 WORKING DAYS BEFORE SET-UP. ANY APPLICATION RECEIVED WITH LESS THAN 4 WORKING DAYS BEFORE THE START OF SET UP, WILL IMPLY A 25% SURCHARGE ON THE TOTAL RATE. AVAILABILITY OF ALL REFERENCES IS NOT GUARANTEED. PLEASE SEND THIS FORM BY EMAIL: servicecenter@feriavalencia.com

Date, signature, and company stamp

Date: Valencia, / / 202....

2022

TRADE FAIR:

Exhibiting Firm:

Contact:

Stand Number:

E-mail:

DRAW THE PLAN OF LOCATION OF ELECTRICAL ACCESSORIES

The plan **MUST** be sent. If it is not received, the location of the services will be up to FERIA VALENCIA, with no possibility of further changes during the assembly of the stand.

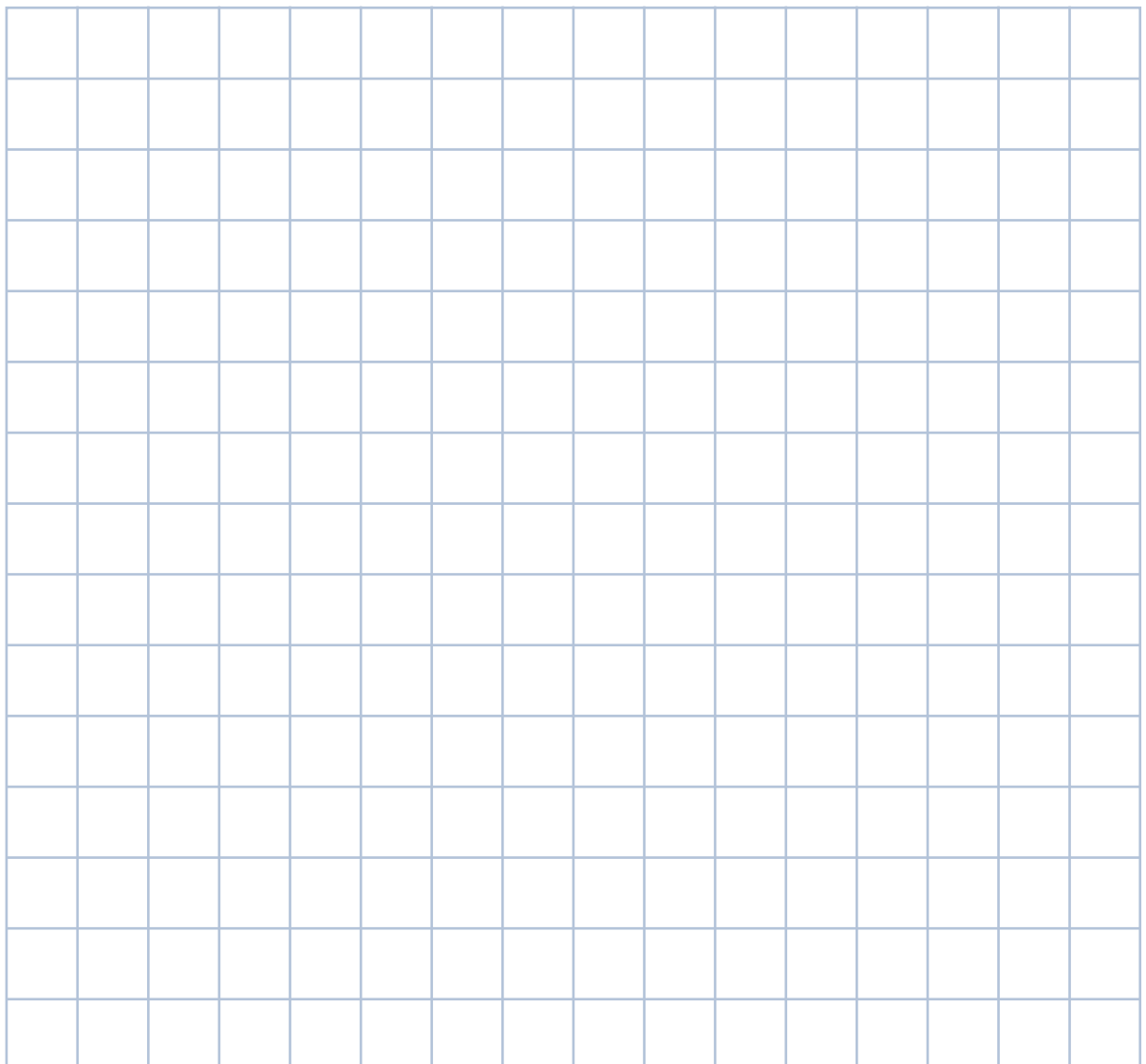

DEADLINE FOR SENDING THIS FORM: 4 WORKING DAYS BEFORE SET-UP.
PLEASE SEND THIS FORM BY EMAIL: servicecenter@feriavalencia.com

2022

TRADE FAIR:	
Exhibiting Firm:	
Contact:	Stand Number:
E-mail:	

RATES (VAT not included)

DESCRIPTION	LANGUAGE	QUANTITY	RATE IN EUROS	TOTAL EUROS
<input type="checkbox"/> Exhibition Hostess	Spanish		126,00	
<input type="checkbox"/> Exhibition Hostess	1 foreign language		128,00	
<input type="checkbox"/> German <input type="checkbox"/> French <input type="checkbox"/> English <input type="checkbox"/> Italian				
<input type="checkbox"/> Exhibition Hostess	2 foreign language		134,00	
<input type="checkbox"/> German <input type="checkbox"/> French <input type="checkbox"/> English <input type="checkbox"/> Italian				
<input type="checkbox"/> Hostess for Promotion	Spanish		134,00	
<input type="checkbox"/> Hostess for Promotion	1 foreign language		138,00	
<input type="checkbox"/> German <input type="checkbox"/> French <input type="checkbox"/> English <input type="checkbox"/> Italian				
<input type="checkbox"/> Interpreter Hostess	1 foreign language		192,00	
<input type="checkbox"/> German <input type="checkbox"/> French <input type="checkbox"/> English <input type="checkbox"/> Italian				
<input type="checkbox"/> Interpreter Hostess	2 foreign language		226,00	
<input type="checkbox"/> German <input type="checkbox"/> French <input type="checkbox"/> English <input type="checkbox"/> Italian				
<input type="checkbox"/> Extra Hour Hostess			28,25	
<input type="checkbox"/> Extra Hour Interpreter Hostess			17,25	

SPECIFICATIONS OF THIS SERVICE

- These rates are for one labour day during 8 hours + 1 hour for meal.
- All the hostess have uniform.
- Minimum half day (4 hours).

* Details of what is included in the rate is detailed in the next page.

FROM:	<input type="text"/>	<input type="text"/>	TO:	<input type="text"/>	<input type="text"/>
	DAY	MONTH		DAY	MONTH
TIMETABLE FROM:	<input type="text"/>	<input type="text"/>	TIMETABLE TO:	<input type="text"/>	<input type="text"/>
	HOUR	MINUTES		HOUR	MINUTES

· Every timetable exceeding 9 hours (8 hrs + 1 hrs for meal) will be rated as extra hour.

DEADLINE FOR SENDING THIS FORM: 4 WORKING DAYS BEFORE SET-UP. ANY APPLICATION RECEIVED WITH LESS THAN 4 WORKING DAYS BEFORE THE START OF SET UP, WILL IMPLY A 25% SURCHARGE ON THE TOTAL RATE. AVAILABILITY OF ALL REFERENCES IS NOT GUARANTEED. PLEASE SEND THIS FORM BY EMAIL: servicecenter@feriavalencia.com

Date, signature, and company stamp

2022

DETAILS OF THE TASKS:

· EXHIBITION HOSTESS

Visitors attention. Information on products. Stand control. Corporate Image. Link between clients and sellers. Purchase orders. Potential clients captation.

· HOSTESS FOR PROMOTION

Their main task is to link their image to a product.

· INTERPRETER HOSTESS

Technical translations and business dialogue. Document writing. Business with clients. Guided visits.

· HOSTESS COORDINATOR

Control the hostess group by supervising their tasks. Defined by the job.

2022

TRADE FAIR:	
Exhibiting Firm:	
Contact:	Stand Number:
E-mail:	

RATES (VAT not included)

DESCRIPTION	QUANTITY	RATE IN EUROS	TOTAL EUROS
<input type="checkbox"/> Security Guard - Day Shift		178,00	
<input type="checkbox"/> Security Guard - Half Day		89,50	
<input type="checkbox"/> Security Guard - Night Shift		185,00	
<input type="checkbox"/> Assistant - Day Shift		147,50	
<input type="checkbox"/> Assistant - Half Day		73,75	
<input type="checkbox"/> Assistant - Night Shift		191,10	
<input type="checkbox"/> Waiter		138,00	
<input type="checkbox"/> Ham Master Slicer		Ask for customised quote	
<input type="checkbox"/> Extra Hour (Any Service)		23,00	

TERMS OF SERVICE

· One full working day includes eight hours. (half day 4 hours)

Day Shift : 6:00 - 22:00

Night Shift : 22:00 - 6:00

FROM:	<input type="text"/>	<input type="text"/>	TO:	<input type="text"/>	<input type="text"/>
	DAY	MONTH		DAY	MONTH
TIMETABLE FROM:	<input type="text"/>	<input type="text"/>	TIMETABLE TO:	<input type="text"/>	<input type="text"/>
	HOUR	MINUTES		HOUR	MINUTES

· Every timetable exceeding 8 hours will be rated as extra hour.

If you interested in any other service not included in this form, please contact us.

E-mail: servicecenter@feriavalencia.com

DEADLINE FOR SENDING THIS FORM: 4 WORKING DAYS BEFORE SET-UP. ANY APPLICATION RECEIVED WITH LESS THAN 4 WORKING DAYS BEFORE THE START OF SET UP, WILL IMPLY A 25% SURCHARGE ON THE TOTAL RATE. AVAILABILITY OF ALL REFERENCES IS NOT GUARANTEED. PLEASE SEND THIS FORM BY EMAIL: servicecenter@feriavalencia.com

Date, signature, and company stamp

2022

TRADE FAIR:

Exhibiting Firm:

Contact:

Stand Number:

E-mail:

RATES (VAT not included)

DESCRIPTION	QUANTITY	EUROS / UNIT	TOTAL EUROS
<input type="checkbox"/> Touch Screen 24 " Full HD		203	
<input type="checkbox"/> Screen 43" Smart TV 4K with Stand		162	
<input type="checkbox"/> Screen 50" Smart TV 4K with Stand		223	
<input type="checkbox"/> Screen 55" Smart TV 4K with Stand		257	
<input type="checkbox"/> Screen 65" Smart TV 4K with Stand		473	
<input type="checkbox"/> Screen 75" Smart TV 4K with Stand		610	
<input type="checkbox"/> Screen 80" Smart TV 4K with Stand		675	
<input type="checkbox"/> Screen 90" Smart TV 4K with Stand		1215	
<input type="checkbox"/> Wall Stand for Screen 40"-80"		95	
<input type="checkbox"/> Foot Stand for Screen up to 65"		102	
<input type="checkbox"/> LEDWALL 2*2 Modules 47" HD		945	
<input type="checkbox"/> LEDWALL 2*2 Modules 55" HD		2734	
<input type="checkbox"/> LEDWALL 3*3 Modules 55" HD		3342	
<input type="checkbox"/> 2500-3500 LUMEN PROJECTOR VGA/HDMI		203	
<input type="checkbox"/> 3500-5500 LUMEN PROJECTOR VGA/HDMI		215	
<input type="checkbox"/> AUDIO KIT SC		203	
<input type="checkbox"/> MICROPHONE FOR STAND/CONFERENCE		37	
<input type="checkbox"/> HEADBAND/DIADEM MICROPHONE		122	
<input type="checkbox"/> HAND MICROPHONE		61	
<input type="checkbox"/> PRESS RACK 16 MEDIA		108	
<input type="checkbox"/> Technical Production Personner (Hour)		25	

* See terms and conditions for orders on back

If you interested in any other service not included in this form, please contact us.
E-mail: servicecenter@feriavalencia.com

DEADLINE FOR SENDING THIS FORM: 4 WORKING DAYS BEFORE SET-UP. ANY APPLICATION RECEIVED WITH LESS THAN 4 WORKING DAYS BEFORE THE START OF SET UP, WILL IMPLY A 25% SURCHARGE ON THE TOTAL RATE. AVAILABILITY OF ALL REFERENCES IS NOT GUARANTEED. PLEASE SEND THIS FORM BY EMAIL: servicecenter@feriavalencia.com

Date, signature, and company stamp

Date: Valencia, / / 202....

2022

These rates INCLUDE:

- The rental of the equipment during the entire show.
- The maintenance and replacement in case of malfunction.
- Any cables and wiring that do not need to be incorporated into the decorative elements of the booth. Any installation that requires this service will be invoiced separately.

If you are interested in ordering another type of product that is not included in this form, please contact us. E-mail: servicecenter@feriavalencia.com

2022

TRADE FAIR:	
Exhibiting Firm:	
Contact:	Stand Number:
E-mail:	

DRAW THE PLAN OF LOCATION OF AUDIOVISUAL ACCESSORIES

The plan **MUST** be sent. If it is not received, the location of the services will be up to FERIA VALENCIA, with no possibility of further changes during the assembly of the stand.

**DEADLINE FOR SENDING THIS FORM: 4 WORKING DAYS BEFORE SET-UP.
PLEASE SEND THIS FORM BY EMAIL: servicecenter@feriavalencia.com**

2022

TRADE FAIR:	
Exhibiting Firm:	
Contact:	Stand Number:
E-mail:	

RATES (VAT not included)

DESCRIPTION	QUANTITY	EUROS / UNIT	TOTAL EUROS
<input type="checkbox"/> Landtop Computer 15,4 "		102,00 €	
<input type="checkbox"/> APPEL IMAC 27"		432,00 €	
<input type="checkbox"/> Monochrome Multifunction Printer		122,00 €	
<input type="checkbox"/> additional toner monochrome		35,00 €	
<input type="checkbox"/> Appel IPAD PRO		125,00 €	
<input type="checkbox"/> Mechaniced Stand Speaker / Conference		122,00 €	
<input type="checkbox"/> Charging Station USB (8 ports)		122,00 €	

If you are interested in ordering another type of product that is not included in this form, please contact us. E-mail: servicecenter@feriavalencia.com

DEADLINE FOR SENDING THIS FORM: 4 WORKING DAYS BEFORE SET-UP. ANY APPLICATION RECEIVED WITH LESS THAN 4 WORKING DAYS BEFORE THE START OF SET UP, WILL IMPLY A 25% SURCHARGE ON THE TOTAL RATE. AVAILABILITY OF ALL REFERENCES IS NOT GUARANTEED. PLEASE SEND THIS FORM BY EMAIL: servicecenter@feriavalencia.com

Date, signature, and company stamp

APPLICATION FORM

2022

TRADE FAIR:

Exhibiting Firm:

Contact:

Stand Number:

E-mail:



RATES (VAT not included)

DESCRIPTION	QUANTITY	EUROS / UNIT	TOTAL EUROS
<input type="checkbox"/> Madagascar Tree		30,00	
<input type="checkbox"/> Kentia Palm (180 cm)		60,00	
<input type="checkbox"/> Kentia Palm (140 cm)		45,00	
<input type="checkbox"/> Weeping Fig (180 cm)		45,00	
<input type="checkbox"/> Weeping Fig (140 cm)		33,00	
<input type="checkbox"/> Umbrella Tree (140 cm)		23,00	
<input type="checkbox"/> Trained Tree (140 cm)		45,00	
<input type="checkbox"/> Centrepiece		38,00	
<input type="checkbox"/> Flowerbox 60x30		31,00	
<input type="checkbox"/> Flowerbox 80x30		38,00	
<input type="checkbox"/> Esterlicia Augusta (130-180 cm)		45,00	

CUSTOMIZED GARDEN SERVICE

This service needs to be rated separately.

- All plants include a decorative flowerpot holder.
- This rates include the flower rental during the show.

If you are interested in ordering another type of product not included in this form, please contact us. E-mail: servicecenter@feriavalencia.com

DEADLINE FOR SENDING THIS FORM: 4 WORKING DAYS BEFORE SET-UP. ANY APPLICATION RECEIVED WITH LESS THAN 4 WORKING DAYS BEFORE THE START OF SET UP, WILL IMPLY A 25% SURCHARGE ON THE TOTAL RATE. AVAILABILITY OF ALL REFERENCES IS NOT GUARANTEED. PLEASE SEND THIS FORM BY EMAIL: servicecenter@feriavalencia.com

Date, signature, and company stamp

Date: Valencia, / / 202....

APPLICATION FORM

2022

TRADE FAIR:

Exhibiting Firm:

Contact:

Stand Number:

E-mail:

COFFEE MACHINE AND BEER DRAFT

DESCRIPTION	QUANTITY	Ask for rates
<input type="checkbox"/> Single-Use Coffee Machine	<input type="text"/>	<input type="text"/>
<input type="checkbox"/> Beer Draft	<input type="text"/>	<input type="text"/>

COMPLEMENTS

DESCRIPTION		
<input type="checkbox"/> Intense Coffee	<input type="checkbox"/> Milk	<input type="checkbox"/> Glass 160 cc
<input type="checkbox"/> Decaffeinated Coffee	<input type="checkbox"/> Sticks in Box	<input type="checkbox"/> Glass 120 cc
<input type="checkbox"/> Tee	<input type="checkbox"/> Sugar	<input type="checkbox"/> Beer
<input type="checkbox"/> Mint - Tee	<input type="checkbox"/> Sweetener	
<input type="checkbox"/> Camomile Tee	<input type="checkbox"/> Sweetened Milk	

To contract the service please contact the company:

PAN Y LA SAL RESTAURANT

CONTACT PERSONS: vdelvalle@feriapalace.es

- Vicente del Valle - Email:restaurantelpanylasal@gmail.com - Phone: +34 600.580.547
- M^a Ángeles López - Email:restaurantelpanylasal@gmail.com - Phone: +34 963.861.410

Date, signature, and company stamp

APPLICATION FORM

2022

TRADE FAIR:	
Exhibiting Firm:	
Contact:	Stand Number:
E-mail: APPLICATION FORM	



RATES (VAT not included)

DESCRIPTION	QUANTITY	EUROS / UNIT	TOTAL EUROS
<input type="checkbox"/> FP 90 refrigerator		69,00	
<input type="checkbox"/> FG 130 refrigerator		78,00	
<input type="checkbox"/> BP 100 bottle rack		113,00	
<input type="checkbox"/> Microwave		31,25	
<input type="checkbox"/> Horizontal freezer		78,00	
<input type="checkbox"/> Vertical freezer		78,00	
<input type="checkbox"/> Beer draft	NEEDS TO BE RATED SEPARATELY		

SPECIFICATIONS OF THIS SERVICE

- The rates include the rental of these articles during the entire show.
- See reverse side for technical specifications of these appliances.

If you are interested in ordering another type of product that is not included in this form, please contact us. E-mail: servicecenter@feriavalencia.com

DEADLINE FOR SENDING THIS FORM: 4 WORKING DAYS BEFORE SET-UP. ANY APPLICATION RECEIVED WITH LESS THAN 4 WORKING DAYS BEFORE THE START OF SET UP, WILL IMPLY A 25% SURCHARGE ON THE TOTAL RATE. AVAILABILITY OF ALL REFERENCES IS NOT GUARANTEED. PLEASE SEND THIS FORM BY EMAIL: servicecenter@feriavalencia.com

Date, signature, and company stamp

TECHNICAL SPECIFICATIONS

2022

- **FP - 90 REFRIGERATOR:** Small, single-door refrigerator (includes freezer compartment). Brand: Zanussi - Thor
Dimensions: Height: 850 mm. Width: 550 mm. Depth: 600 mm.
Capacity: Freezer compartment: 18 litres - Refrigerator Capacity: 122 Litres - Total Net Cap'y.: 140 Litres
Consumption: 234 W/h. Measurements and values are approximate.
- **FG - 130 REFRIGERATOR:** Double-door refrigerator (freezer on top). Brand: Aspes
Dimensions: Height: 1,300 cm. Width: 560 mm. Depth: 600 mm.
Capacity: Freezer compartment: 45 litres - Refrigerator Capacity: 163 Litres - Total Net Cap'y.: 208 Litres
Consumption: 328 W/h. Measurements and values are approximate.
- **BP - 100 BOTTLE RACK:** Bottle cooler, horizontally sliding doors on top.
Material: Stainless steel and fibreglass-reinforced polyester. Brand: Asfri
Dimensions: Height: 850 mm. Width: 1,010 mm. Depth: 570 mm.
Capacity: 208 Litres, equivalent to 263 32-cl. bottles. Weight: 39 kg.
- **MICROWAVE:** Several models, with and without grill. Daewoo - Samsung, power: 800W and 1050W
- **HORIZONTAL FREEZER:** Brand: IGNIS ICF - 331. Freezer chest type.
Dimensions: Height: 890 mm. Width: 1,120 mm. Depth: 660 mm. Capacity: 320 Litres - Consumption: 172 W/h.
- **VERTICAL FREEZER:** Brand: TECHWOOD TW-245. Freezer cabinet.
Dimensions: Height: 1,450 mm. Width: 550 mm. Depth: 600 mm. Capacity: 190 Litres. Consumption: 172 W/h.

APPLICATION FORM

2022

TRADE FAIR:

Exhibiting Firm:

Contact:

Stand Number:

E-mail:



Female / Male Mannequin w/head

Female / Male Mannequin w/o head

Torso, Female, Male, Child

Expandable rack

RATES (VAT not included)

DESCRIPTION	QUANTITY	EUROS / UNIT	TOTAL EUROS
<input type="checkbox"/> Female / Male Mannequin, flesh-colored, with head and makeup	F. <input type="text"/> M. <input type="text"/>	90,00	
<input type="checkbox"/> Female / Male Mannequin, white, without head	F. <input type="text"/> M. <input type="text"/>	90,00	
<input type="checkbox"/> Torso, Female, sizes 8 to 24		25,00	
<input type="checkbox"/> Torso, Male, sizes 38 to 40		25,00	
<input type="checkbox"/> Torso, Child, sizes 6 mos. and 2/4/6/10 and 12 years		23,00	
<input type="checkbox"/> Expandable Chrome Rack, 4.6 ft./140 cm. - 6.6 ft./2 m. Height: 6.6 ft./2 m.		30,00	

This service INCLUDES:

- The rental of the items for the entire show.
- The shipping of the materials.

If you are interested in ordering another type of product not included in this form, please contact us. E-mail: servicecenter@feriavalencia.com

DEADLINE FOR SENDING THIS FORM: 4 WORKING DAYS BEFORE SET-UP. ANY APPLICATION RECEIVED WITH LESS THAN 4 WORKING DAYS BEFORE THE START OF SET UP, WILL IMPLY A 25% SURCHARGE ON THE TOTAL RATE. AVAILABILITY OF ALL REFERENCES IS NOT GUARANTEED. PLEASE SEND THIS FORM BY EMAIL: servicecenter@feriavalencia.com

Date, signature, signer's name and company stamp.

2022

TRADE FAIR:	
Exhibiting Firm:	
Contact:	Stand Number:
E-mail:	

DIGITAL PICTURES

RATES (VAT not included)

DESCRIPTION	RATE IN EUROS	TOTAL EUROS
<input type="checkbox"/> Pictures outside the stand (4 units)	56,25	
<input type="checkbox"/> Stand Illustrated Report 32 sq.m (8 units)	100,00	
<input type="checkbox"/> Stand Illustrated Report 32 to 64 sq.m (12 units)	137,50	
<input type="checkbox"/> Stand Illustrated Report more than 64 sq.m (16 units)	162,50	
<input type="checkbox"/> Stand Illustrated Report more than 64 sq.m (20 units)	181,25	

SPECIFICATIONS OF THIS SERVICE

- The pictures will be handed in CD or DVD format.
- The pictures will be handed in during the show if the service is requested at least with 48 hours in advance.
- The rate includes post-production, handling and picture adaption.

PRINTED COPIES

RATES (VAT not included)

DESCRIPTION	EUROS UNIT	UNITS	TOTAL EUROS
<input type="checkbox"/> Copies of Photos 20x30	10,00		
<input type="checkbox"/> Copies of Photos 30x45	16,25		
<input type="checkbox"/> Copies of Photos 40x60	27,50		
<input type="checkbox"/> Copies of Photos 50x75	40,00		
<input type="checkbox"/> Copies of Photos 70x100	50,00		

SPECIFICATIONS OF THIS SERVICE

- The pictures will be handed in high resolution paper copy.
- The pictures will be handed in during the show if the service is requested at least with 48 hours in advance.
- The rate includes post-production, handling and picture adaption.

Services not included in this form need to be rated separately. Please contact us:
E-mail: servicecenter@feriavalencia.com

**DEADLINE FOR SENDING THIS FORM: 4 WORKING DAYS BEFORE SET-UP.
PLEASE SEND THIS FORM BY EMAIL: servicecenter@feriavalencia.com**

Date, signature, and company stamp

2022

TRADE FAIR:	
Exhibiting Firm:	
Contact:	Stand Number:
E-mail:	

Feria Valencia offers a custom-made service video recording + edition in different formats and qualities to the exhibitors according to their needs.

AVAILABLE RECORDING FORMATS:

- Standard quality (BETACAM SP, DV o DVC PRO)
- High Definition (DVC PRO HD)

POST-PRODUCTION WITH LINEAR EDITING WITH MUSIC:

- Standard quality (DVD)
- High Definition (BLU-RAY)

EXTRA SERVICES:

- Announcement
- Authoring DVD (Interactive Menus)

QUALITIES:

- Standard: 720 x 576 Pixels (Video Production)
- High Definition: 1920 x 1080 Pixels (Cinema Productions and Digital Transmission).

For service rates, please contact:
E-mail: servicecenter@feriavalencia.com

DEADLINE FOR SENDING THIS FORM: 4 WORKING DAYS BEFORE SET-UP. ANY APPLICATION RECEIVED WITH LESS THAN 4 WORKING DAYS BEFORE THE START OF SET UP, WILL IMPLY A 25% SURCHARGE ON THE TOTAL RATE. AVAILABILITY OF ALL REFERENCES IS NOT GUARANTEED. PLEASE SEND THIS FORM BY EMAIL: servicecenter@feriavalencia.com

Date, signature, and company stamp

2022

OFFICIAL SUPPLIERS

EL PAN Y LA SAL RESTAURANT

CONTACT PERSONS:

- **Vicente del Valle** - Email: restaurantelpanylasal@gmail.com - vdelvale@feriapalace.com
Mobile: +34 600.580.547
- **M^a Ángeles López** - Email: mlopez@feriapalace.com

Phone: +34 96 386 12 79 - +34 96 396 12 42 Office Hours: 9:00 a 20:00 h.

Fax: +34 96 386 12 44

CAFETERÍAS ZURIAGA, S.L.U.

CONTACT PERSON:

- **Consuelo Zuriaga** - Email: consu11@hotmail.es - Mobile: +34 607.416.002

Phone: +34 963 86 12 29

Office hours: 10:00 a 13:00 h.

2022

TRADE FAIR:

Exhibiting Firm:

Contact:

Stand Number:

E-mail:

Feria Valencia offers a custom-made service vinyls and giant prints in different formats and qualities to the exhibitor's according to their needs:

MAIN QUALITY AND FORMAT PRINTS:

- Walkable flooring
- Self-adhesive
- Photographic paper
- Coated paper
- Vinyl
- Shaped stickers

SPECIFICATIONS OF THIS SERVICE:

- The rates include production, instalation and removal.
- Rates calculation is per m2.

For service rates, please contact:
E-mail: servicecenter@feriavalencia.com

DEADLINE FOR SENDING THIS FORM: 4 WORKING DAYS BEFORE SET-UP. ANY APPLICATION RECEIVED WITH LESS THAN 4 WORKING DAYS BEFORE THE START OF SET UP, WILL IMPLY A 25% SURCHARGE ON THE TOTAL RATE. AVAILABILITY OF ALL REFERENCES IS NOT GUARANTEED. PLEASE SEND THIS FORM BY EMAIL: servicecenter@feriavalencia.com

Date, signature, and company stamp

2022

TRADE FAIR:	
Exhibiting Firm:	
Contact:	Stand Number:
E-mail:	

Feria Valencia offers the following painting services with a customised quote according to requirements:

PAINTING SERVICES:

- Water-Based Semi-Matte Paint WHITE
- Water-Based Semi-Matte Paint COLOUR (According to Sample Colours)
- Water-Based Paint SATIN FINISH
- Faux Paint CEMENT
- Faux Paint OXIDE
- Decorative Textured Sand
- Clear Water-Based Varnish
- Floor staining
- Faux Water-Based STUCCO
- SYNTHETIC ENAMEL paint
- WATER-BASED ENAMEL paint
- BLACKBOARD paint for manual jobs
- MAGNETIC paint for Exhibitions.

For service rates, please contact:
E-mail: servicecenter@feriavalencia.com

DEADLINE FOR SENDING THIS FORM: 4 WORKING DAYS BEFORE SET-UP. ANY APPLICATION RECEIVED WITH LESS THAN 4 WORKING DAYS BEFORE THE START OF SET UP, WILL IMPLY A 25% SURCHARGE ON THE TOTAL RATE. AVAILABILITY OF ALL REFERENCES IS NOT GUARANTEED. PLEASE SEND THIS FORM BY EMAIL: servicecenter@feriavalencia.com

Date, signature, and company stamp

SOLICITUD

2022

TRADE FAIR:	
Exhibiting Firm:	
Contact:	Stand Number:
E-mail:	



Feria Valencia offers you the possibility of these services which can be customised according to your personal requirements:

Contact us for obligation-free advice on the best options for having fun with your company:

E-mail: servicecenter@feriavalencia.com

ENTERTAINMENT:

We have a wide range of activities and shows that will help reinforce your brand image. Our style of working is elegant and unique and is based on the concepts of innovation, creativity, humour, and distinction, with each event adapted to the specific needs of our clients.

Contact us for obligation-free advice on the best options for making your business stand out from the rest at the Fair.

- Prize-giving
- Product presentations
- Stand entertainment
- Ceremonies
- Shows for dinner events
- Themed shows
- Brand image promotion

OUTDOOR / INDOOR TEAM BUILDING:

We offer you a whole range of activities to help you maximise your visit to the Fair, activities that help strengthen team spirit and a sense of belonging, or just simply allow you to release stress and to enjoy your stay at our facilities.

Our activities are tried and tested, with a focus on professionalism and humour, and will give participants an unforgettable emotional experience as well as excellent training in group development for their organisation.

- Team marbling (teams work together to build an aqueduct, includes different tests).
- Formula 1 team (teams work together to build cars, and then compete in a race).
- Company quiz show (highly entertaining quiz show, with company-related questions).
- City treasure hunts (treasure hunt in Valencia's historical centre).
- Multi-activities (a series of tests involving team working).
- Laughter therapy workshop.

DEADLINE FOR SENDING THIS FORM: 4 WORKING DAYS BEFORE SET-UP. ANY APPLICATION RECEIVED WITH LESS THAN 4 WORKING DAYS BEFORE THE START OF SET UP, WILL IMPLY A 25% SURCHARGE ON THE TOTAL RATE. AVAILABILITY OF ALL REFERENCES IS NOT GUARANTEED. PLEASE SEND THIS FORM BY EMAIL: servicecenter@feriavalencia.com

Fecha, firma, nombre firmante y sello de la Empresa.

2022

TRADE FAIR:	
Exhibiting Firm:	
Contact:	Stand Number:
E-mail:	

RATES (VAT not included)

DESCRIPTION	EUROS / UNIT	TOTAL EUROS
<input type="checkbox"/> Canvas, Outside Perimeter	1.050,00	
<input type="checkbox"/> Canvas, Fire Escapes CV-31 Road	5.250,00	
<input type="checkbox"/> Canvas, Fire Escapes Central Forum	5.250,00	
<input type="checkbox"/> Canvas, Outside North Forum	4.000,00	
<input type="checkbox"/> Banner circuit, double-side, Outside	4.275,00	
<input type="checkbox"/> Vinyl, Outside Pavilion 8	3.500,00	
<input type="checkbox"/> SET, feather banner on pole with base, CENTRAL FORUM	3.600,00	
<input type="checkbox"/> SET, feather banner on pole with base, NORTH FORUM	3.600,00	
<input type="checkbox"/> Vinyl, Elevators Back	1.350,00	
<input type="checkbox"/> Banner circuit, double-sided, indoor (18 units)	5.400,00	
<input type="checkbox"/> Vinyl, Stairs Side	1.350,00	
<input type="checkbox"/> Vinyl, Stairs Back	1.125,00	
<input type="checkbox"/> Floor Adds	1.875,00	
<input type="checkbox"/> Vinyl, Windows Pavilion Entrance	675,00	
<input type="checkbox"/> Vinyl, Windows, Side of Entrance	712,50	
<input type="checkbox"/> Vinyl, Windows, descent to Pavilion, L1	675,00	
<input type="checkbox"/> Vinyl, Windows access to Pavilion 6 and 8	975,00	
<input type="checkbox"/> SET Litter Baskets, L2 Hall (30 units)	2.250,00	
<input type="checkbox"/> Vinyl, lighted, parking garage	225,00	
<input type="checkbox"/> Vinyl, Windows, Entrance to parking garage P2	375,00	
<input type="checkbox"/> Vinyl Panels Toilets (27 units)	1.000,00	

ALL FEES INCLUDE PRODUCTION, INSTALLATION AND REMOVAL.

The references O.1 to O.12 - Canvas, Fire Escapes - These types of canvas are reusable. Storage service is available, if desired. Please enquire about fees.

DEADLINE FOR SENDING THIS FORM: 4 WORKING DAYS BEFORE SET-UP. ANY APPLICATION RECEIVED WITH LESS THAN 4 WORKING DAYS BEFORE THE START OF SET UP, WILL IMPLY A 25% SURCHARGE ON THE TOTAL RATE. AVAILABILITY OF ALL REFERENCES IS NOT GUARANTEED. PLEASE SEND THIS FORM BY EMAIL: servicecenter@feriavalencia.com

Date, signature, and company stamp

2022

OUTDOOR ADVERTISING MEDIA



Ref.: N.1 to N.6
Canvas, outside perimeter
3'5 x 1'5 m.
6 units available



Ref.: O.1 to O.12
Canvas, fire escapes
10 x 10 m.
12 units available



Ref.: R.1 to R.6
Canvas, outside North Forum
6 x 3 m.
6 units available



Ref.: P.1 to P.15
Banner circuit, double-
sided outdoor
0,75 x 2 m.
15 units



Ref.: S.1 to S.2
Vinyl, outside Pavilion 8
6 x 8 m.
2 units available

INDOOR MEDIA LEVEL 2 HALL CENTRAL FORUM



Ref.: A.1 to A.8
Vinyl, elevators back
3,70 x 2,70 m.
8 units available



Ref.: B.1 to B.18
Banner circuit, double-sided
indoor 0,60 x 3 m.
18 units



Ref.: C.1 to C.6
Vinyl, stairs side
0,90 x 7,60 m.
6 units available



Ref.: D.1 to D.4
Vinyl, stairs back
5,70 x 1,35 m.
4 units available

ACCESSES CENTRAL FORUM AND NORTH FORUM



Ref.: 1.1 to 1.16
Set, feather banner on pole
with base, Central Forum
4,7 x 0,80 m.
6 units



Ref.: Q.1 to Q.6
Set, feather banner on pole
with base, North Forum
4,7 x 0,80 m.
6 units

APPLICATION FORM

2022

INDOOR MEDIA LEVEL 2 HALL CENTRAL FORUM



Ref.: E.1 to E.5
Floor adds.
3 x 5 m.
5 units available



Ref.: F.1 to F.8
Vinyl, windows pavilion
entrance
1 x 3,50 m.
8 units available



Ref.: G.1 to G.2
Vinyl, windows side of
entrance
1 x 3,90 m.
2 units available



Ref.: H.1 to H.6
Vinyl, windows descent to
pavilion L1
0,90 x 3,50 m.
6 units available



Ref.: 1.1 to 1.2
Vinyl, windows access to
pavilion 6,7 and 8
0,95 x 5,90 m.
2 units available

INDOORMEDIA LEVEL 2 HALL CENTRAL FORUM



Ref.: K.1 to K.30
Set litterbaskets, L2 hall
Ø 60 cm.
30 units



Ref.: L.1 to L.4
Vinyl, lighted, parking garage
1,45 x 1,90 m.
4 units available



Ref.: M.1 to M.2
Vinyl, windows, entrance to
parking garage P2
0,60 x 3,40 m.
2 units available

INDOORMEDIA TOILETS LEVEL 2 HALL AND PAVILLIONS



Ref.: N.1 a N.27
Panels Toilets:
0,38x0x50 cm.
27 units

INFORMATION

FERIA VALENCIA will produce the advertising to be displayed in its advertising vehicles, in accordance with the technical characteristics that will be provided upon the purchase of advertising space.

For more specific information, please contact:
servicecenter@feriavalencia.com

2022

TRADE FAIR:	
Exhibiting Firm:	
Contact:	Stand Number:
E-mail:	

1. The passes required for setting-up and dismantling of stands will be issued by the Setting-up Department. All passes are PERSONAL and NON-TRANSFERABLE.
2. To obtain these passes, the exhibiting company must fill in and return this form. At the same time, it must also fulfil the requirements indicated in the Guide for hiring services attached to these forms. (Point 2.1)
3. All persons within the Feria Valencia exhibition centre must be in possession of a valid setting-up and dismantling pass, which must be shown to security personnel on demand.
4. The passes are valid up until (2) hours before the opening of the event and will be valid again at 8 am on the morning after closing of the event until the deadline stipulated by the Technical Department.
5. Any person not fulfilling these requirements will be asked to leave the premises, and will be forbidden access until such time as a Technical Department deems fit.
6. It is the sole responsibility of the exhibitor to ensure that all staff working at its stand are insured against work accidents and are covered by health services, committing itself to strictly comply with the 31/1995 Law on Prevention of Work Risks dated 8 November, as well as its subsequent extensions and modifications.

THE ABOVE MENTIONED EXHIBITING COMPANY APPLIES FOR THE NECESSARY AUTHORIZATION AND FOR ASSEMBLER PASSES FOR THE PERSONNEL IN CHARGE. IN THIS CONNECTION, HE/SHE DECLARES UNDER HIS/HER RESPONSABILITY, THAT SAID PERSONNEL, IS WITHOUT ANY EXCEPTION, INSURED AGAINST THE RISK OF INDUSTRIAL ACCIDENTS, AT (Name of the insurance company):

.....
INSURANCE No:

NAME AND SURNAME	ID. PASSPORT No.
.....	<input type="text"/>
.....	<input type="text"/>
.....	<input type="text"/>
.....	<input type="text"/>
.....	<input type="text"/>
.....	<input type="text"/>
.....	<input type="text"/>

DEADLINE FOR SENDING THIS FORM: 4 WORKING DAYS BEFORE SET-UP.
PLEASE SEND THIS FORM BY E-MAIL OR FAX: personalmontajes@feriavalencia.com +34 96 386 13 07

Date, signature, and company stamp

APPLICATION FORM

2022

TRADE FAIR:

Exhibiting Firm:

Contact:

Stand Number:

E-mail:

1. The Exhibitor Pass is the document accrediting the holder as an exhibitor. It will be issued in the name of the exhibiting company.

2. Each exhibitor is entitled to 4 Exhibitor Passes for the first module of 16m² (or other area as stipulated by the fair in question), plus 2 further passes for each subsequent module, up to a maximum of 100 passes. The exhibitor must supply the names and positions of the persons to whom the passes will be issued.

3. Exhibitor passes can be collected at the Treasury Office at Feria Valencia, once all outstanding payments have been paid, as stipulated in the Conditions for Participation of the trade fair.

EXPOSITORS CARDS

To stand 16 m/s	4 Passes.	To stand de 192 m/s	26 Passes.	To stand de 352 m/s	46 Passes.
To stand de 32 m/s	6 Passes.	To stand de 208 m/s	28 Passes.	To stand de 368 m/s	48 Passes.
To stand de 48 m/s	8 Passes.	To stand de 224 m/s	30 Passes.	To stand de 384 m/s	50 Passes.
To stand de 64 m/s	10 Passes.	To stand de 240 m/s	32 Passes.	To stand de 400 m/s	52 Passes.
To stand de 96 m/s	12 Passes.	To stand de 256 m/s	34 Passes.	To stand de 416 m/s	54 Passes.
To stand de 112 m/s	14 Passes.	To stand de 272 m/s	36 Passes.	To stand de 432 m/s	55 Passes.
To stand de 128 m/s	16 Passes.	To stand de 288 m/s	38 Passes.	To stand de 448 m/s	56 Passes.
To stand de 144 m/s	18 Passes.	To stand de 304 m/s	40 Passes.	To stand de 464 m/s	58 Passes.
To stand de 160 m/s	20 Passes.	To stand de 320 m/s	42 Passes.	To stand de 480 m/s	60 Passes.
To stand de 176 m/s	24 Passes.	To stand de 336 m/s	44 Passes.	To stand de 496 m/s	62 Passes.

IMPORTANT-If you want to extend this amount, must indicate at the time of collecting those assigned by default in the Treasury Office of Feria Valencia.

**DEADLINE FOR SENDING THIS FORM: 4 WORKING DAYS BEFORE SET-UP.
PLEASE SEND THIS FORM BY EMAIL: servicecenter@feriavalencia.com**

Date, signature, and company stamp

Date: Valencia, / / 202....

APPLICATION FORM

2022

TRADE FAIR:	
Exhibiting Firm:	
Contact:	Stand Number:
E-mail:	

- 1. "Full pre-show" Cleaning Service
- 2. "Maintenance" Cleaning Service (per action)
- 3. "Spot" Cleaning Service

RATES (VAT not included)

DESCRIPTION	QUANTITY		RATES	TOTAL EUROS
1. "Full pre-show" Cleaning Service	sq.m		2,51 €/sq.m	
2. "Maintenance" Cleaning Service (per action)	sq.m	n° of times:	0,85 €/sq.m	
	FROM: <input type="text"/> <input type="text"/> DAY MONTH		TO: <input type="text"/> <input type="text"/> DAY MONTH	
3. "Spot" Cleaning Service maximum service 1 hr.			15,88 €/hour	
	DATE: <input type="text"/> <input type="text"/> DAY MONTH		HOUR: <input type="text"/> <input type="text"/>	
SPOT SERVICES NEEDED: <input style="width: 400px;" type="text"/>				

The three types of service include:

- The "FULL PRE-SHOW" service includes the thorough cleaning of all the components of the stand (including glass surfaces) up to a height of two metres, once the assembly of the stand has been completed, and before the show is officially opened.
- The "MAINTENANCE" cleaning service includes a maintenance cleaning of all the components of the stand (including glass surfaces) up to a height of two metres during the time the show is held. This service may be requested as often as needed.
Please indicate the number of times you will need the MAINTENANCE service.
- The SPOT cleaning service includes several specific services: dish washing, cleaning lavatories installed in the stand itself, cleaning carpet or other floor covering, and continuous cleaning.

DEADLINE FOR SENDING THIS FORM: 4 WORKING DAYS BEFORE SET-UP. ANY APPLICATION RECEIVED WITH LESS THAN 4 WORKING DAYS BEFORE THE START OF SET UP, WILL IMPLY A 25% SURCHARGE ON THE TOTAL RATE. AVAILABILITY OF ALL REFERENCES IS NOT GUARANTEED. PLEASE SEND THIS FORM BY EMAIL: servicecenter@feriavalencia.com

Date, signature, and company stamp